



WARNING

PLEASE READ ALL INSTRUCTIONS BEFORE ATTEMPTING INSTALLATION

- To prevent personal injury or product damage only licensed electricians should install.
- To avoid electric shock or component damage disconnect power before attempting installation or servicing.
- Disconnect product and allow cooling prior to servicing.
- Any alteration or modification of this product is forbidden as it may cause personal injury, death, property damage and/or product malfunction.
- To prevent product malfunction and/or electrical shock this product must be properly grounded.
- This luminaire is designed to operate in ambient temperatures ranging from -40°C to 45°C.
- MIN 75°C SUPPLY CONDUCTORS.
- CONSULT A QUALIFIED ELECTRICIAN TO ENSURE CORRECT BRANCH CIRCUIT CONDUCTOR.
- Do not switch under load.
- Caulk to mounting surface at all sides.

INSTALLATION

1. Use the Hex Wrench to loose the 2 Allen Screws. And take apart the mounting bracket from the fixture. (Fig 1)

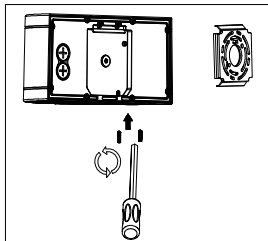

Fig 1

2. Install the mounting bracket to the junction box. (Fig 2)

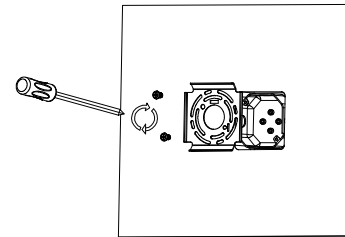

Fig 2

3. Attach the safety cable to the bracket to hold the fixture onto the wall. (Fig 3)

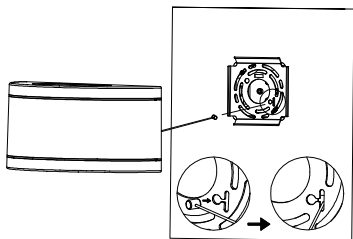

Fig 3

4. Connect wires according to below wire diagram. (Fig 4)

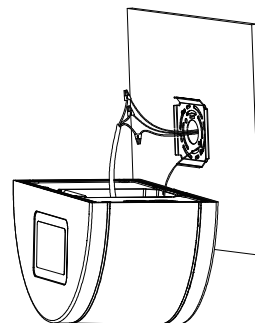
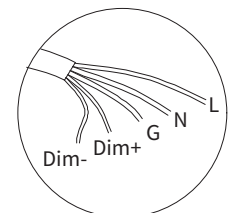

Fig 4



Black	○	Line
White	○	Neutral
Green	○	Ground
Purple	○	Dim+
Pink	○	Dim-

5. Follow the arrow direction to slide the fixture onto the mounting bracket. (Fig 5)

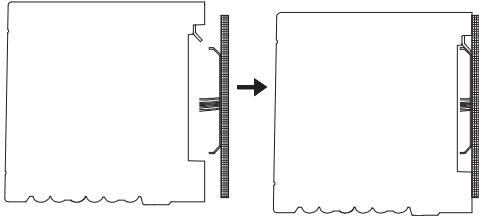

Fig 5

6. Tighten the 2 Allen Screws and installation is completed. (Fig 6)

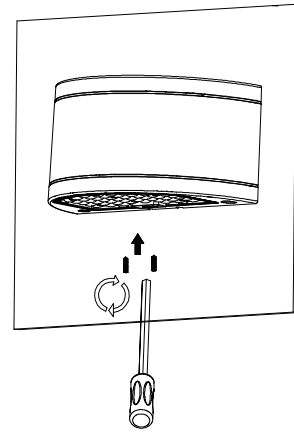
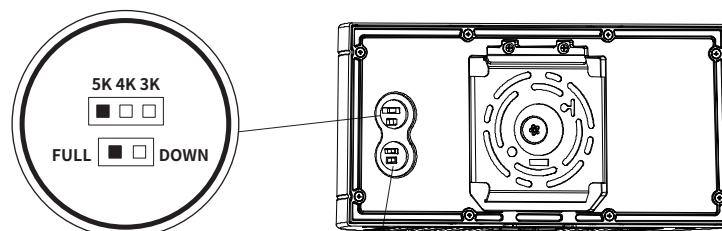

Fig 6

WATTAGE & CCT SELECTABLE GUIDANCE

Default Setting:
Watt: 40W/80W CCT: 5000K Photocell: ON Light control: Full



DIP Switch for CCT & Down / Full Light Control

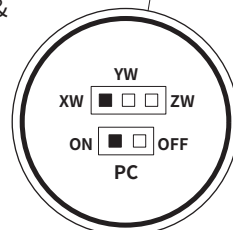

DIP Switch for Watt & Photocell

<input checked="" type="checkbox"/>	XW = 40	80
<input type="checkbox"/>	YW = 32	64
<input type="checkbox"/>	ZW = 24	48