



## Features:

- 1, Easy Installation with integrated design
- 2, Battery can support 3-5 nights with cloudy days
- 3, Super Bright led , Aluminum case , never fade
- 4, Waterproof Ip65
- 5, Different Power for your options

## Specifications:

Length	30cm	60cm	120cm
LED	5W	10W	20W
Solar panel	4.5W	9W	18W
Battery	Rechargeable Lithium-ion Battery		
Sensor	Light sensor		
Life of the led	>50000H		
Product size (cm)	30*6.7*11.5	60*6.7*11.5	120*6.7*11.5
			

Note: The light will automatically turn off when it detects low voltage from the battery. This might happen after 3-4 cloudy days. For best charging performance place light in as much direct sunlight as possible.

# User Manual

INTEGRATED SOLAR BILLBOARD LED LIGHT  
WALL LIGHT/BILLBOARD LIGHT/SIGN LIGHT

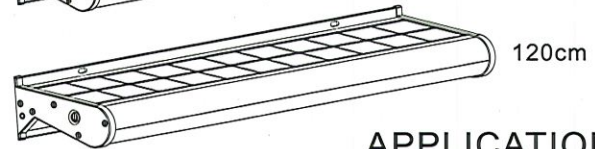
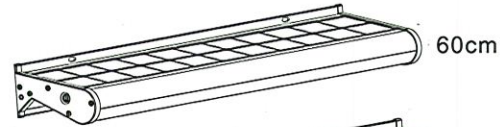

## APPLICATIONS

- Pathway
- Wall
- Fence
- Billboard
- Sign Board

RoHS

CE

FC



IP65



## Product Structure Diagram

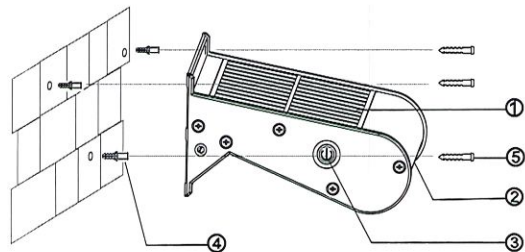

- 1. Solar Panel
- 2. LEDs Panel
- 3. ON/OFF

- 4. Wall Anchor(3PCS)
- 5.Screws(3PCS)

## Installation Steps

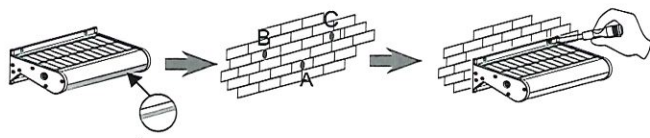

Please remove protect film from lens.

Drill three holes on the support surface and set one screw from A , then hang the solar light.

Fix the solar light with screws on B+C

## Working Steps

