

## INSTALLATION INSTRUCTIONS

### WARNING

1. This product must be installed in accordance with the applicable installation code by a person familiar with the construction and operation of the product and the hazards involved.
2. In order to avoid the danger of electric shock, make certain that the power supply is disconnected before installing or performing maintenance.
3. Ensure all mounts are securely attached and will support the weight of the fixture. Failure to properly support fixture may result in damage or injury, for which the manufacturer does not assume responsibility.

FIGURE 1

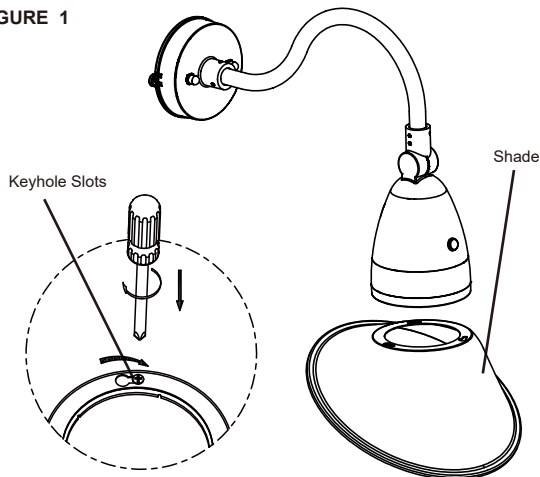

### SHADE INSTALLATION

NOTE: Shade is attached the same way to the fixture head as described in these instructions. Angled corn shade is shown in FIGURE 1 for illustration purposes.

1. Loosen the (3) raised screws on the bottom of the luminaire fixture head.
2. Bring shade up to the fixture head and line up the (3) screws from Step 1 with the keyhole slots on the shade.
3. Rotate shade and tighten the (3) screws from Step 1.

### ELECTRICAL CONNECTIONS

Fixture is equipped with universal volt driver 120-277V (ie. 120V, 208V, 240V or 277V)

#### PHASE TO NEUTRAL WIRING 120/277V

1. Connect supply ground to fixture ground (green) lead.
2. Connect supply common to fixture neutral (white) lead.
3. Connect supply Vin to fixture hot (black) lead.

Tuck all wires carefully into wiring chamber ensuring that no wires are pinched.

#### PHASE TO PHASE WIRING 208/240V

1. Connect supply ground to fixture ground (green) lead.
2. Connect supply L1 (Hot) to fixture neutral (white) lead.
3. Connect supply L2 (Hot) to fixture hot (black) lead.

Tuck all wires carefully into wiring chamber ensuring that no wires are pinched.

### MOUNTING

1. Route supply leads through the center of the mounting plate.
2. Put (2) longer screws on the mounting plate.
3. Run (2) short screws through the mounting plate and lock to the junction box. See FIGURE 2
4. Make wiring connections per the ELECTRICAL CONNECTIONS section and push all leads into junction box.
5. Push the fixture and mounting canopy with silicon pad through (2) longer screws and onto installed mounting plate. See FIGURE 3
6. Secure the (2) longer screws with (2) bolts nuts on mounting canopy.

Note: For wet locations, Apply caulk between the silicone pad and the mounting surface to ensure a watertight seal. A high grade caulking material such as silicone rubber should be used.

FIGURE 2

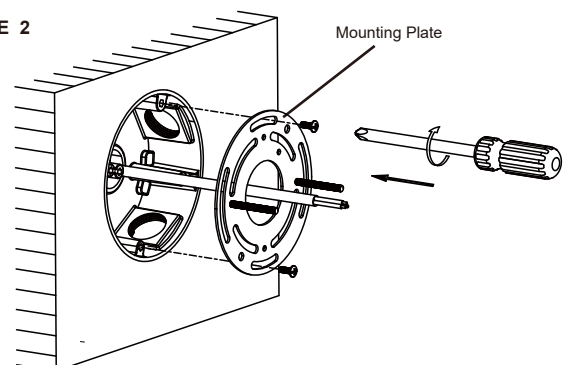
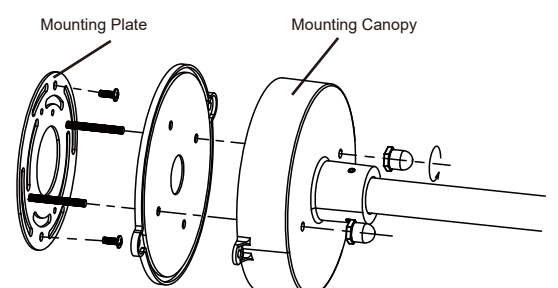

FIGURE 3



## FIXTURE ADJUSTMENT

NOTE: Use the supplied hex key on the set screws on the mounting canopy to level the fixture if necessary. Use the hex key on the set screws on the fixture head to rotate the fixture head left or right as necessary. The Phillips head screw on the fixture head knuckle can be loosened to adjust the tilt angle of the fixture head as necessary.

1. Loosen set screw(s) or Phillips head screw. See FIGURE 4
2. Adjust fixture into desired position. See FIGURE 5
3. Re-tighten screw(s).

FIGURE 4

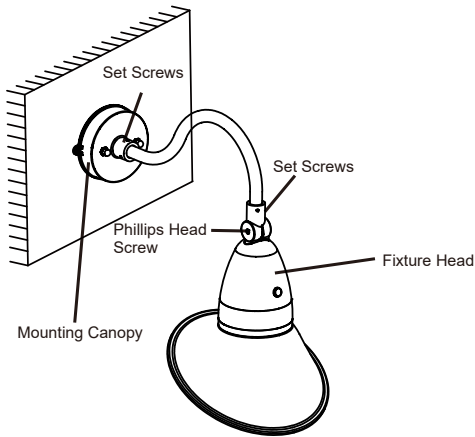
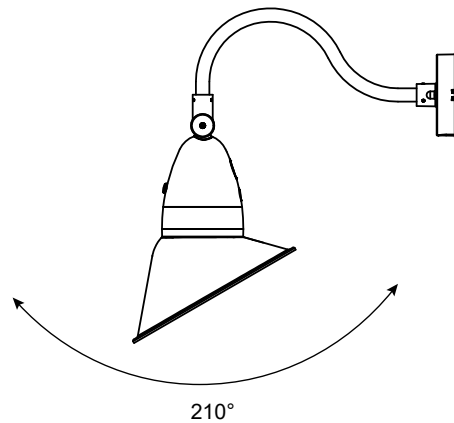

FIGURE 5



## WATTAGE & CCT SELECTION

1. Locate the selector switches on the rear side of the fixture head and unscrew plug to gain access.
2. Built-in photocell for energy efficiency.
3. Select the desired CCT and wattage by sliding the dip switches to the desired values. See FIGURE 6

FIGURE 6

