

IP65 PIR 240°

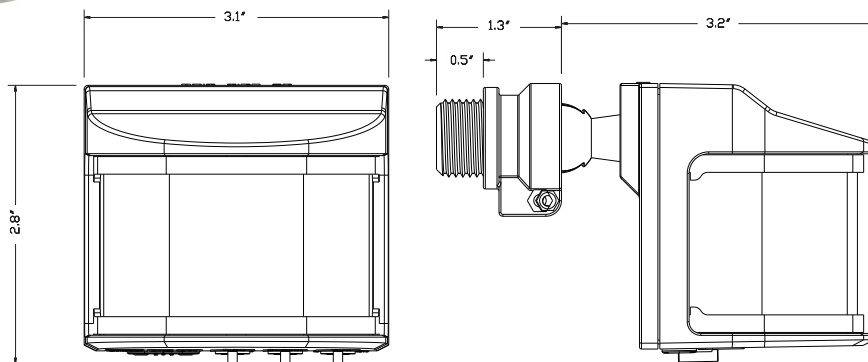

SL-HPIR is a PIR sensor with 240° detection range and maximum 350W LED input. It is suitable for installation on flood lights as new installation or a replacement sensor. It is outdoor rated and made of tough polycarbonate material.



SL-HPIR-BR (Bronze)
SL-HPIR-WH (White)

Voltage	120~277V AC, 50/60Hz
Rated Load	Incandescent - 480W Self Ballast Lamp- 160W LED Lamp - 350W
Detection Zone	19.5 ~ 69 FT. (Adjustable)
Remote Range	50Ft. (15M)
Hold Time	5S. / 5Min.
Mounting Height	13Ft. (4M) Max.
Detection Angle	Horizontal: 240° / Vertical: 90°
Operating Temperature	-4°F ~ 113°F
IP Rating	IP65

