

## LOADING MEDIA TO A FILTER THROUGH THE CANATURE TANK QUICK CONNECT

### STEP 1

- a. Close the bypass valves on the inlet and outlet of the control valve.
- b. Release the pressure in the filter by advancing the control valve to the backwash cycle.
  - i. Instructions are available in the unit's owner's manual.
  - ii. To find an owner's manual, go to [www.canaturewg.com](http://www.canaturewg.com), select the brand of equipment and go to the product page.

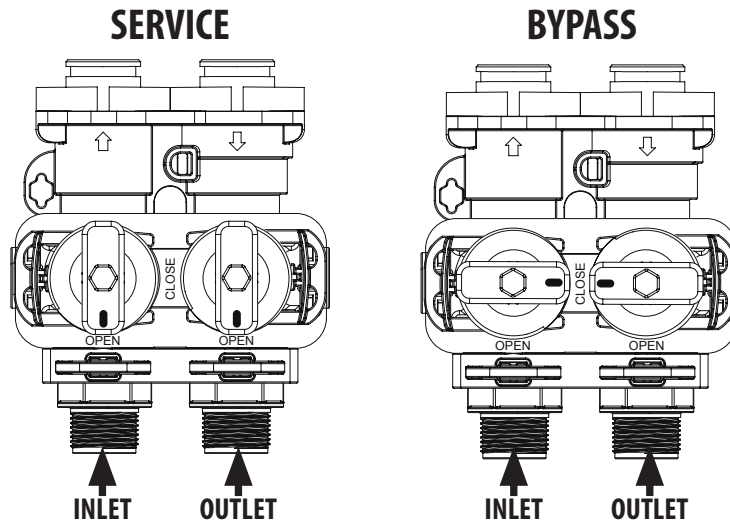

### NOTE

Inlet and outlet configuration may vary depending on the valve type of the filter installed

### STEP 2

1. Once the water pressure is released, unplug the electrical cord.
2. Remove the clips that hold the inlet, outlet and drain the quick connect fittings to the valve and bypass.
3. Remove the inlet, outlet and drain connections.

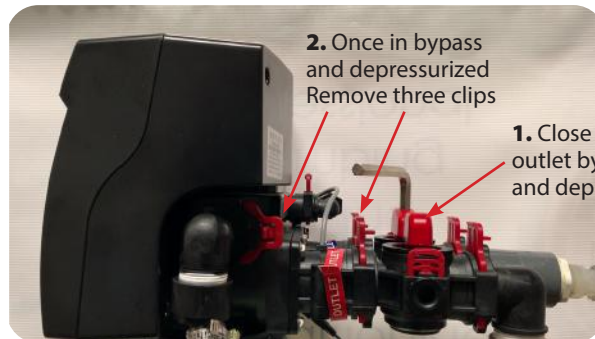

### NOTE

The plumbing may need to be supported or left hanging, depending on the type of plumbing used

### STEP 3

1. Unthread the large nut on the tank quick connect until it is completely loosened.
2. Wiggle the control valve up and remove it from the tank. Carefully set it aside.



## LOADING MEDIA TO A FILTER THROUGH THE CANATURE TANK QUICK CONNECT

### STEP 4

1. Insert the supplied 1/2" flexible tubing all of the way down the center distributor tube until it stops.
2. Place your thumb over the end of the tube to make a seal.
3. Pull the tubing 1/2 to 3/4s of the way out of the distribution tube and bend it down and into a clean, sanitized container.
  - i. This will allow space for the media to flow into the tank and not displace water onto the customers floor.
  - ii. Keep the water that was siphoned into the container for future use.



### STEP 5

1. Install the supplied 3/4" PVC cap onto the top of the distributor tube. This will prevent any media from getting down the center distributor.
2. Insert the funnel into the top of the tank quick connect.
3. Pour media into the funnel.
4. When finished, remove the funnel and push any remaining media into the tank.
5. Using the water siphoned from the tank, carefully pour some onto the tank quick connect to flush any remaining media fines into the tank.
6. Remove the 3/4" PVC cap from the distributor tube.

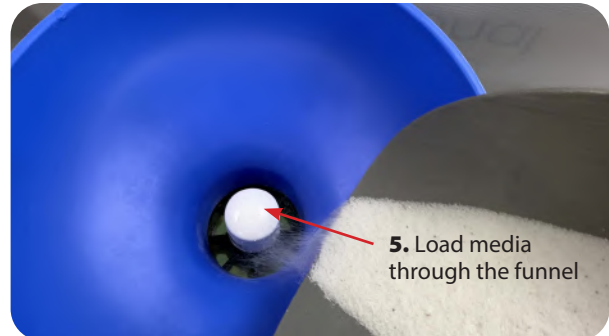
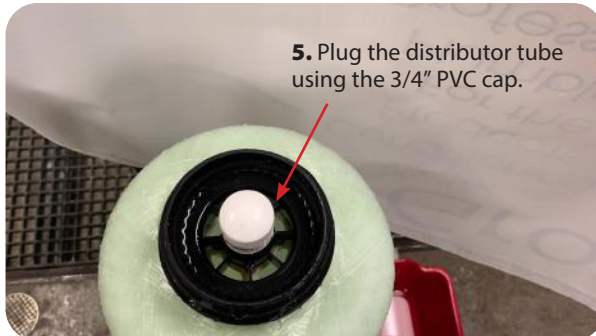

### STEP 6

1. Apply a small amount of the silicone grease to the two o-rings on the valve side of the tank quick connect. Use just enough to shine up the o-ring; don't add too much.
2. Gently install the control valve back onto the top of the tank, pushing it down so the o-ring seats properly.
3. Carefully thread the large nut onto the tank quick connect until it is snug. The nut should thread down very easily; if it doesn't, back it off and start again. Be careful not to cross thread it. Note: Hand tighten only. Do not use a wrench.

6. Grease the o-ring behind the white snap ring and the center distributor tube o-ring



## LOADING MEDIA TO A FILTER THROUGH THE CANATURE TANK QUICK CONNECT

### STEP 7

1. Apply a small amount of silicon grease to the o-rings on the inlet, outlet and drain fittings.
2. Install the inlet, outlet and drain fittings back into the control valve and bypass.
3. Insert the secure clips into these fittings.

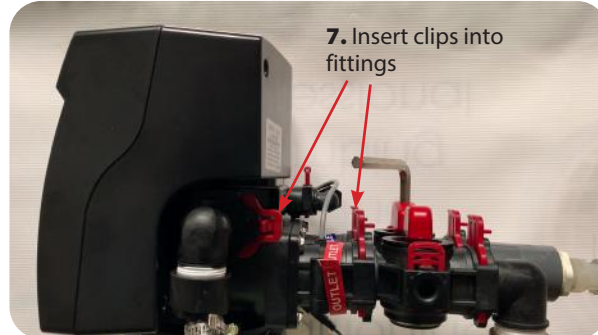

### STEP 8

1. Plug the electrical cord back into the valve. Advance the valve to the service or home position, and then to backwash.
2. Slowly open the inlet valve on the bypass and allow water to enter the filter. Allow all air and water to escape to the drain. When only water is going to the drain, open the inlet valve fully.
3. Allow the filter to backwash for 1 to 2 minutes (to remove any fines from the added media).
4. Advance the valve to the service position and open the outlet valve of the bypass
5. Check for leaks around the inlet, outlet, drain and tank quick connect.
6. Always clean up the work area and leave it cleaner than when you arrived.

**Toll Free: 1-877-288-9888**  
**[www.canaturewg.com](http://www.canaturewg.com)**