



Carolina MeasurePro

Measuring the Carolinas

168 Oakbrook Drive
Advance, NC 27006

336-355-7971

Don@CarolinaMeasurePro.com

These measurements and calculations are performed in accordance with the ANSI z765-2021 Measurement Standard for Calculating Square Footage in Single-Family Residential Buildings

These measurements and calculations are certified as to their accuracy by the NCREC Licensee noted in this report

GREEN & BLUE TOTALS ARE BILLABLE SQUARE FOOTAGE

Copyright© 2009-2026

Carolina MeasurePro®

Carolina Realty Services LLC

NCREC License C-39034

Certified Residential Measure Report				Report Date	Measure Date	Report/PIN #				
				22APR26	22APR26	00516246				
Property Address:		20200 Floral Ln, Cornelius NC			AG Code:	LAMU				
Measure Standard:	SFR/TWH	County:	Meck	Ref/PO #	-	Measured By NCREC Licensee:		J A Williams		
Residential Measure Calculations										
Area Description	Below Grade	Above Grade Heated Living Area	Below Grade Heated Living Area	Heated Non-Living Area	Non-Heated Non-Living Area	Garage (HEATED) Carport Porte/Coch	Ceiling Height Area Exclusion	Other	Decks Porches Patios Balcony	
1 st Floor		2861				473			2979	
2 nd Floor										
3 rd Floor										
4 th Floor										
Basement	X									
Lower Level	X									
Detached Garage										
Outbuildings										
TOTALS		2861				473				
Heated Living Area Square Footage		2861			473	Non-Heated and/or Non-Living Area Square Footage				
Tax Card HLA Comparison		2580			3334	TOTAL SQUARE FOOTAGE			+	
*NOTES:										

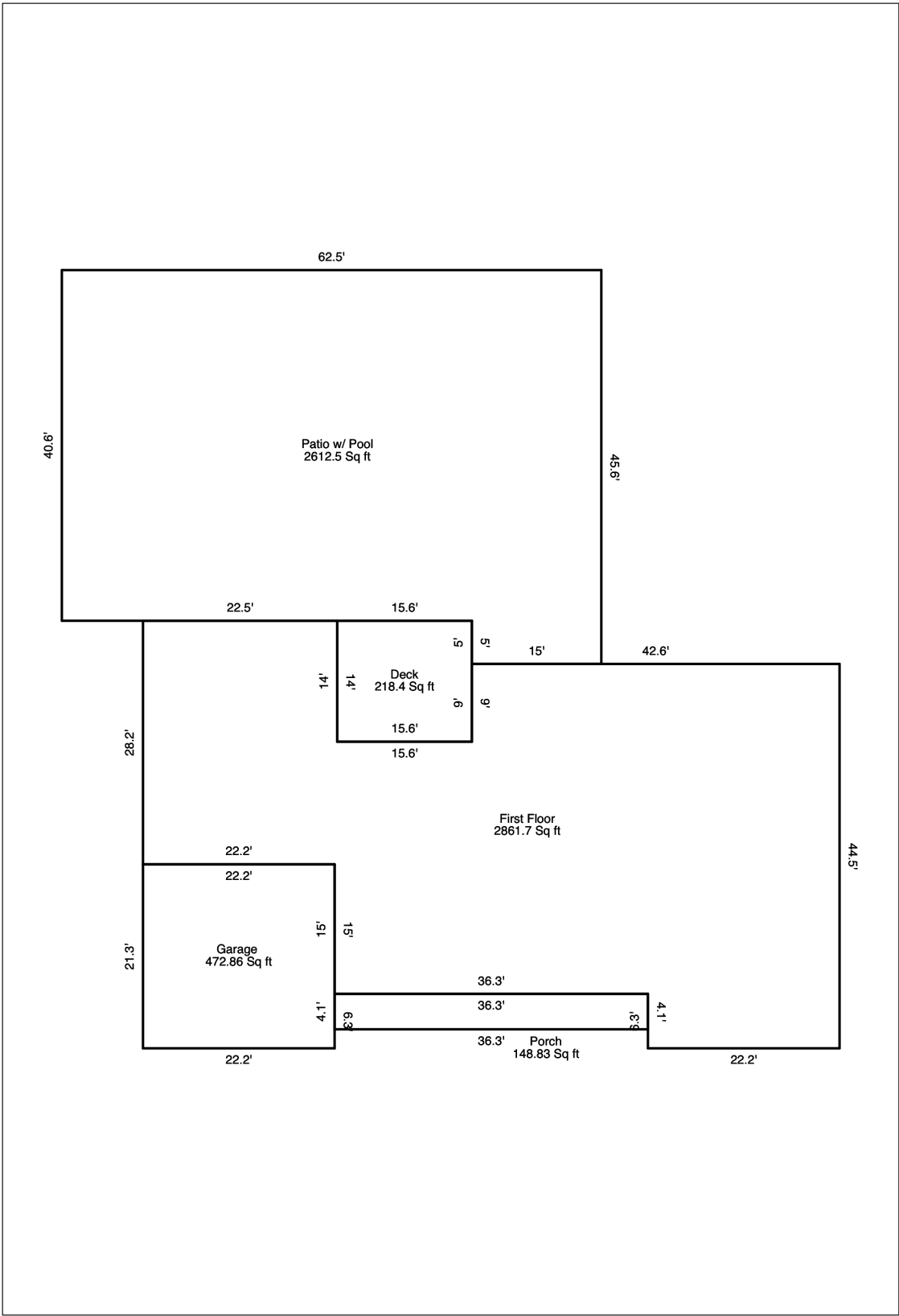

Sketch - Page 1

▼ 1st Floor

**Project 3140 - 20200
Floral Ln**

SUBMITTED BY
Alex Williams
alex.cmpclt@gmail.com
3369773672

CREATED ON
April 22, 2026

LOCATION
20200 Floral Ln
28031 Cornelius
NC

DETAILS
Floors: 1
Rooms: 30

Carolina MeasurePro
168 Oakbrook Dr
27006 Advance
NC
US
Alex.CMPclt@gmail.com
CarolinaMeasurePro.com
336-977-3672

THIS FLOOR PLAN IS PROVIDED WITHOUT WARRANTY OF ANY KIND. CMP DISCLAIMS ANY WARRANTY INCLUDING, WITHOUT LIMITATION, SATISFACTORY QUALITY OR ACCURACY OF DIMENSIONS.

