

ANGLES.	
Each	90°
SIDES.	
ab	100 . 00
bc	100 . 00
cd	100 . 00
da	100 . 00

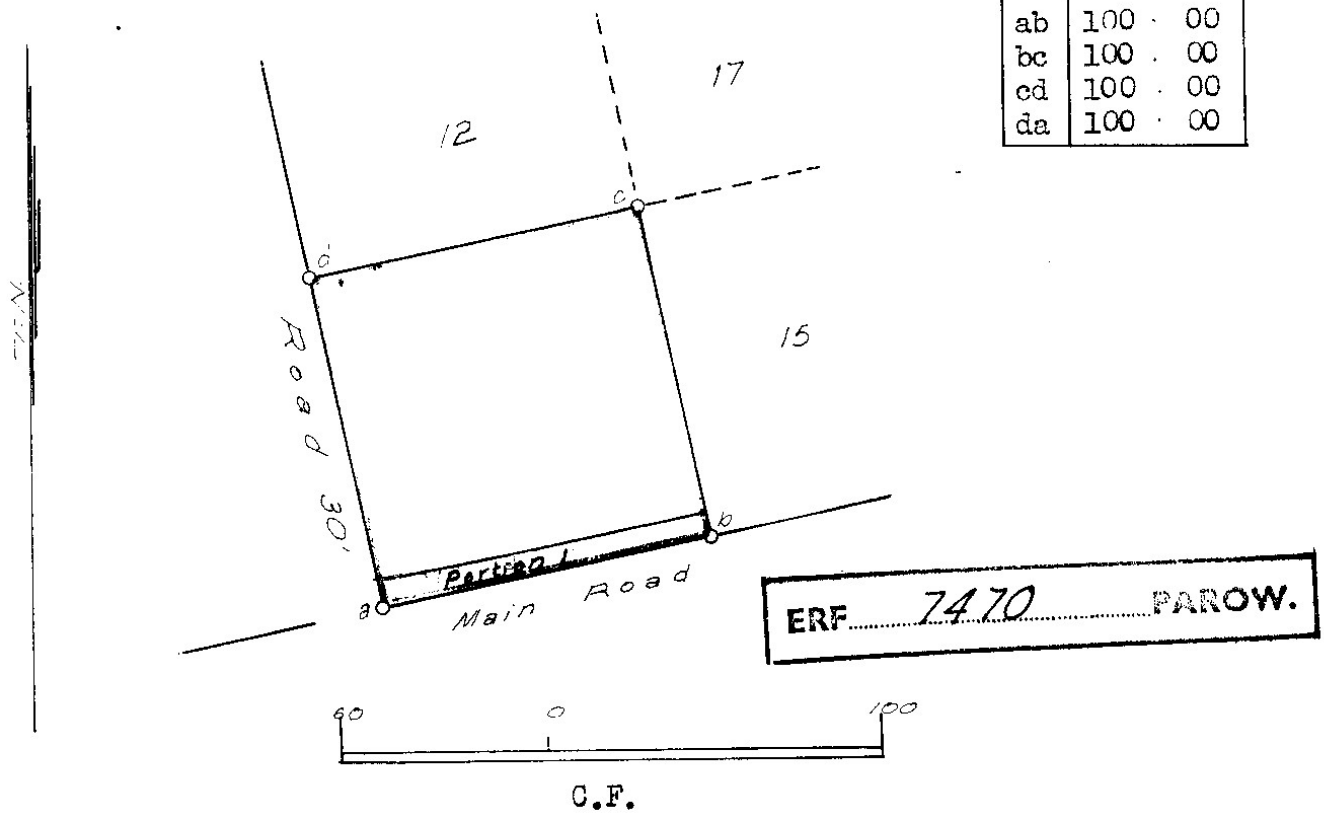

The above Figure, lettered a.b.c.d. represents 69 Square Rods, 64 Square feet of Ground, situated in the F.C. Tygerberg, in the Cape Division, being Lots 13 & 14 Block V of Portion BB of the farm Lovenstein & Zandgat transferred to the South African Natural Mineral Water Company Ltd., Nov., 30th 1898.

Bounded Nwds by Lot 12
 Ewds " Lot 15
 Swds " Main Road
 Wwds " Road 30'

Framed from actual Survey by me.
 (Sgd.) J.J. Bisset.
 Government Surveyor.
 Feb., 1902.

Transfer ——— 66

6th January, 1903

Johanna Mayer

N.S. M677

Cape Town Sheet V4, V5
 Parow.

C