

Michigan State University

University Facilities and Land Use Plan Strategic Directives

Board of Trustees
December 15, 2022



Introduction

The University Facilities and Land Use Plan's Strategic Directives were presented to MSU's Board of Trustees on December 15, 2022. The Infrastructure Planning & Facilities and Institutional Space Planning & Management teams will continue working to advance these initiatives using these directives to guide recommendation refinement as the planning process moves forward.

Strategic Directives

1. MSU operates important education, research, and outreach facilities throughout the state. Disposition or acquisition of land should be based on contributions to these strategic needs, impacts to unique cultural resources, and with acknowledgement that the university occupies or uses ancestral, traditional, and contemporary lands ceded by Indigenous communities.
2. Protect the critical teaching and learning, and research assets within the Agricultural District and Campus Natural Areas including expansion of Baker Woodlot.
3. Concentrate future academic and research facilities in the North, Central, and South Academic Districts; locate external partnerships on the west edge of campus (Harrison Road and Spartan Village).
4. Contribute to student success through concentrated development with a mix of uses providing efficient access to academic resources and collaborative amenities that support the whole student.
5. Develop an integrated mobility and open space network to enhance connectivity across the campus. Re-envision the center of campus with fewer cars.

Statewide Facilities

Key concept:

Land is critical to fulfilling our land grant mission. Large land holdings and AgBioResearch stations should be protected.

How:

- Develop criteria to assess disposition of existing land holdings and acquisition of new.
- Prioritize alignment around:
 - academic success
 - research potential
 - outreach opportunities
 - strategic partnerships
 - cultural resources

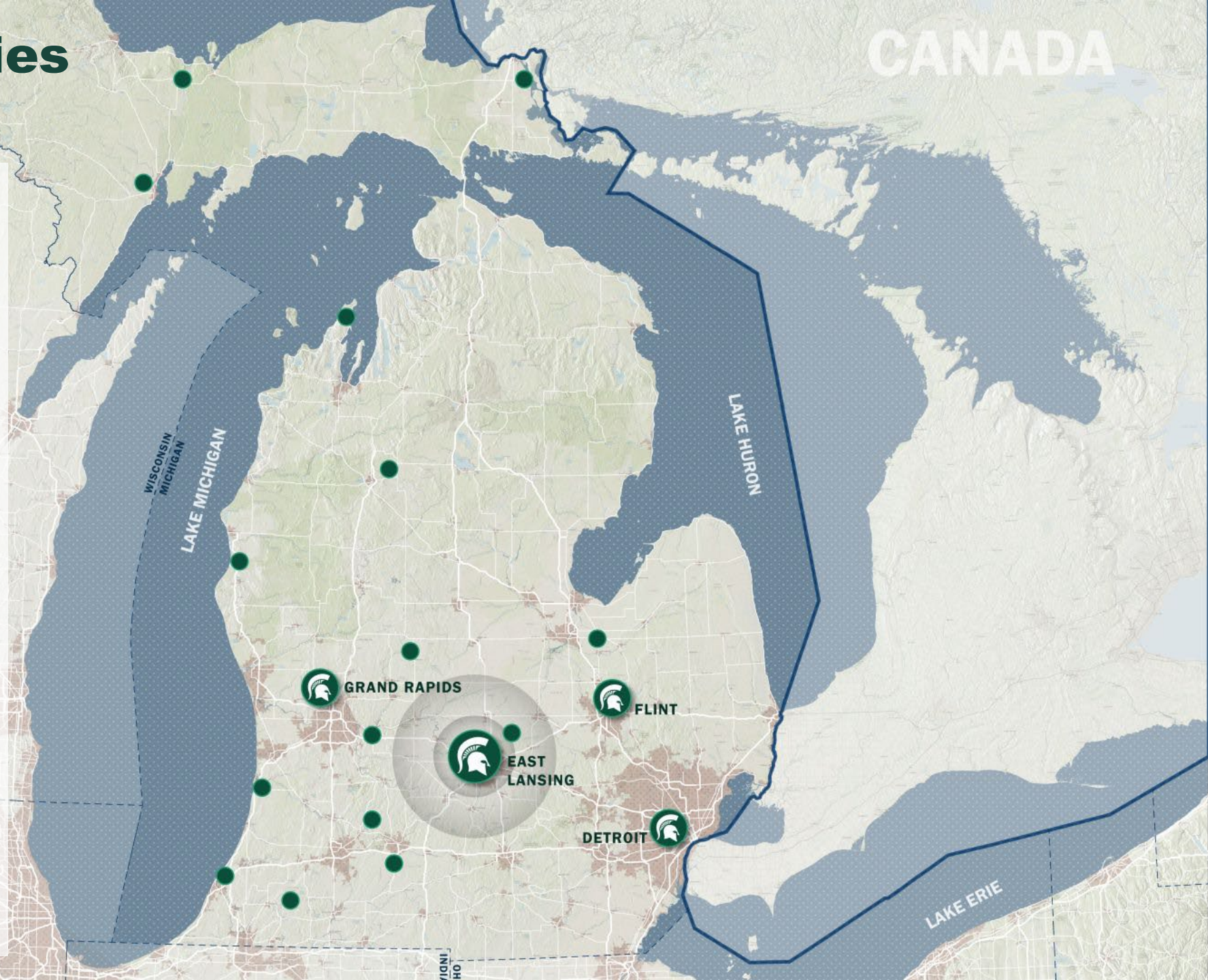

Campus-wide Development Framework

East Lansing Campus

Key concept:

Protect unique resources including agricultural land and campus natural areas.

How:

- Focus new development north of Mount Hope Road and west of Collins Road.
- Develop biological inventories for each natural area that can support existing and prompt new teaching and research.
- Locate external partnerships on the west edge of campus.

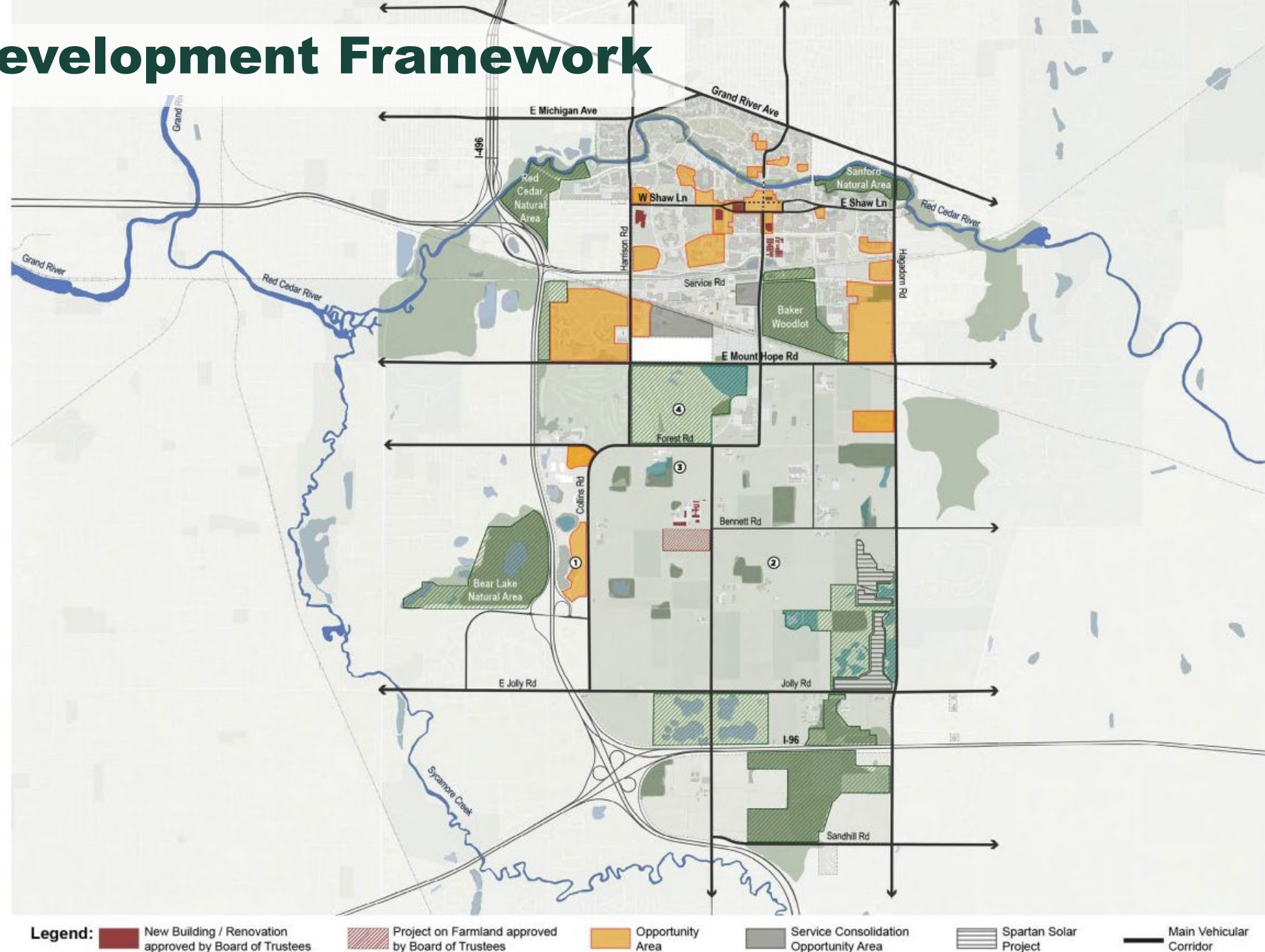

Academic and Research

Proposed Land Use Organization

Key Concept:

Continue to concentrate academic and research facilities to foster interdisciplinary collaboration, communication, and community.

How:

- Focus future academic and research facilities within the North, Central, and South Academic Districts.
- Leverage Harrison Road corridor and Spartan Village land for strategic partnership opportunities.

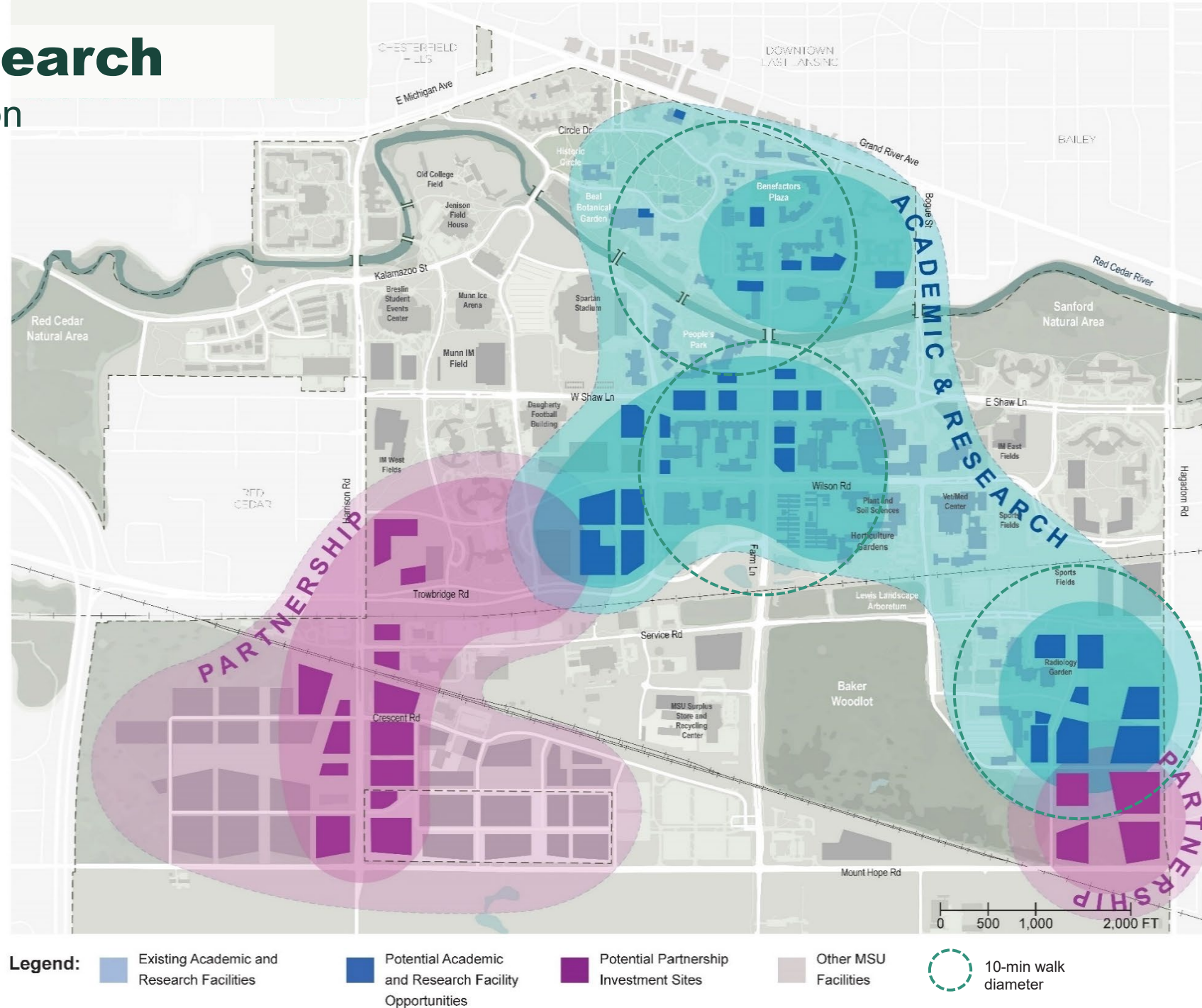

Student Experience

Proposed Land Use Organization

Key Concept:

Build upon the successful residential neighborhood model and promote a mix of uses throughout campus.

How:

- Focus future residence halls within or adjacent to existing residential neighborhoods.
- Provide efficient access to academic resources and collaborative amenities (e.g., classrooms, meeting rooms, student services, dining, etc.).

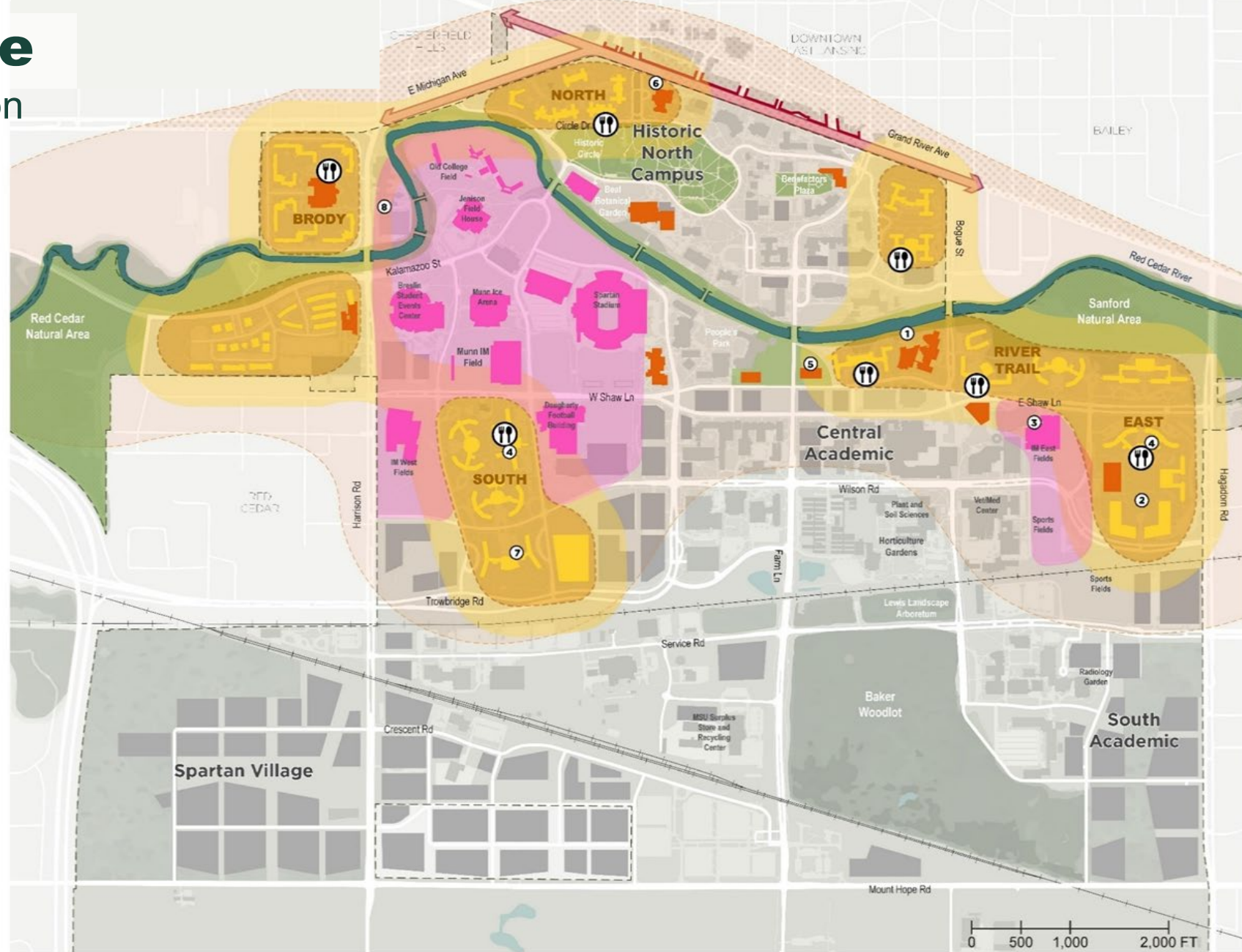

Legend:

Student Housing
(Existing & Potential)

Athletics and Recreation
(Existing & Potential)

Student Collaboration
(Existing & Potential)

Existing Campus
Dining Venues

Other MSU
Facilities

Development Framework Concept

East Lansing Core Campus

Key concept:

Unlock future development opportunities to support strategic initiatives.

How:

- Assess highest and best use of facilities and land to support the University Strategic Plan.
- Expand open space corridors to provide safe and efficient connections with future development.
- Capitalize on the unique landscape systems that create a sense of place for campus neighborhoods.

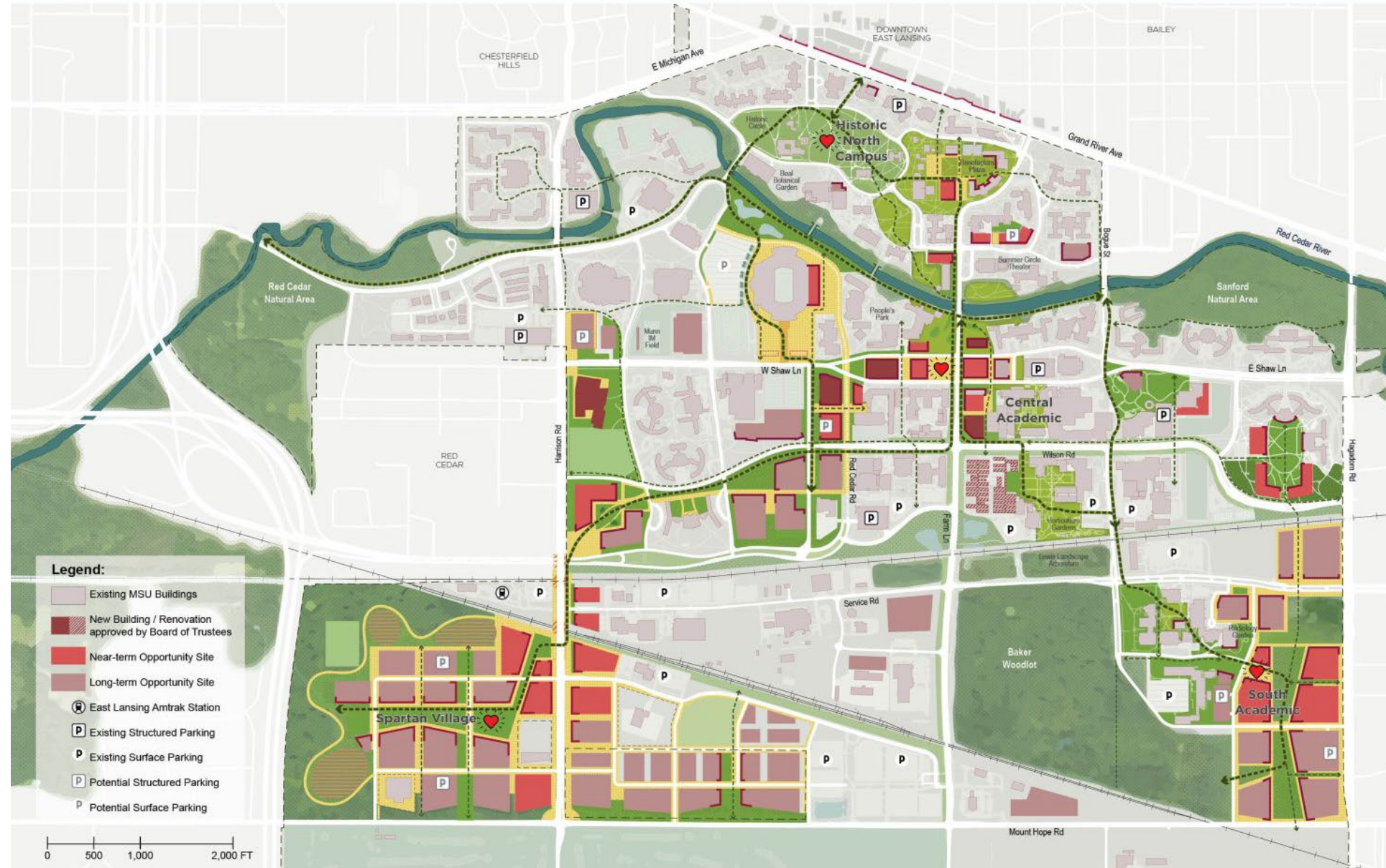

Mobility Network

Proposed Circulation Organization

Key Concept:

Prioritize and enhance pedestrian health and well-being.

How:

- Modify central campus land use patterns to reduce vehicular traffic in favor of non-motorized circulation infrastructure.
- Establish multi-modal corridors that promote improved connectivity, accessibility, and well-being.

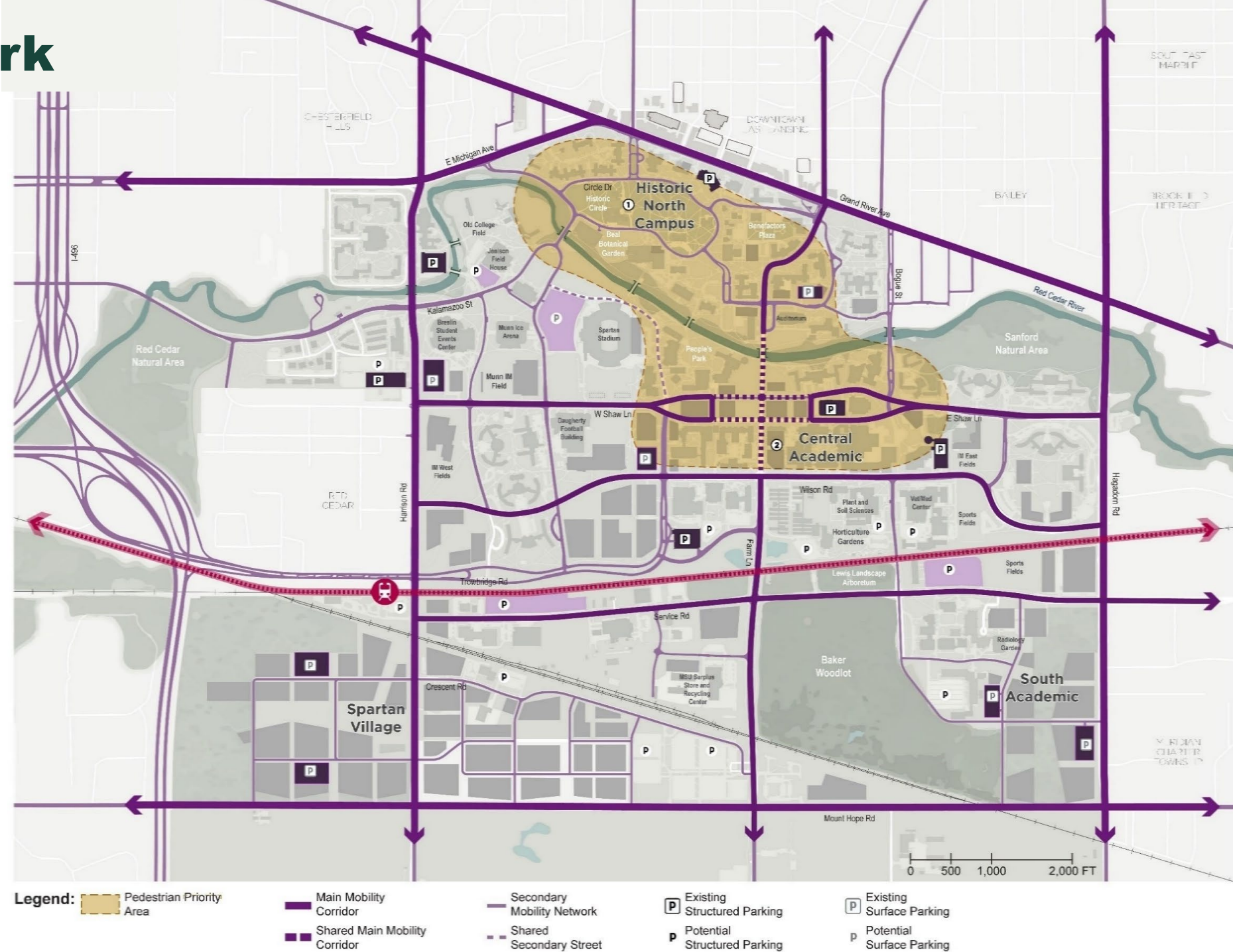

Strategic Directives

1. MSU operates important education, research, and outreach facilities throughout the state. Disposition or acquisition of land should be based on contributions to these strategic needs, impacts to unique cultural resources, and with acknowledgement that the university occupies or uses ancestral, traditional, and contemporary lands ceded by Indigenous communities.
2. Protect the critical teaching and learning, and research assets within the Agricultural District and Campus Natural Areas including expansion of Baker Woodlot.
3. Concentrate future academic and research facilities in the North, Central, and South Academic Districts; locate external partnerships on the west edge of campus (Harrison Road and Spartan Village).
4. Contribute to student success through concentrated development with a mix of uses providing efficient access to academic resources and collaborative amenities that support the whole student.
5. Develop an integrated mobility and open space network to enhance connectivity across the campus. Re-envision the center of campus with fewer cars.