

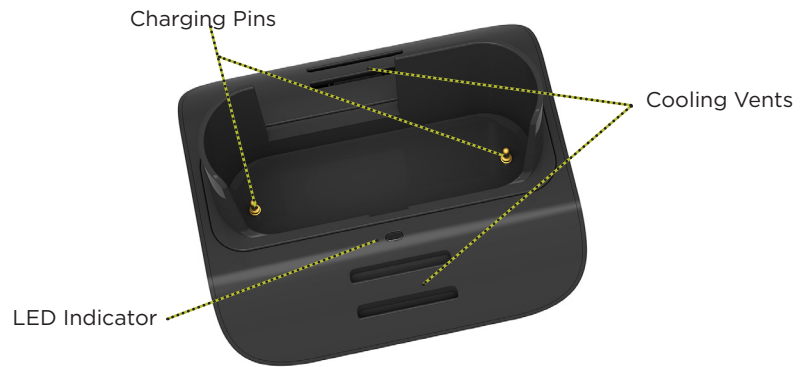

## Infinea® Tab M for iPhone 6 Plus Charging Station (1-Unit)

### QUICK START GUIDE

#### Front View



#### Back View

Attachment for  
Infinea Tab M for iPhone 6 Plus



Mini USB Connector

#### Back View

Attachment for  
Infinea Tab M for iPhone 6 Plus with Rugged Case



Mini USB Connector

### ASSEMBLY

1. Place the charging station on a sturdy, clean and dry surface in an open, well-ventilated area away from direct sunlight.
2. Plug the included USB charge/sync cable into the mini USB connector port on the charging station. Then plug the USB connector into an appropriate external power supply.
3. Gently insert the bottom of the device into the charging bay, ensuring the unit is seated upright so that proper contact is made with the charging pins. The front of the device and the iOS screen should face toward the LED indicator on the charging station.
4. To remove the Infinea® Tab M for iPhone 6 Plus from the charging station, pull the device straight up and out of the charging bay.

**Note:** The Infinea Tab M for iPhone 6 Plus Charging Station (1-Unit) is designed specifically to charge the Infinea Tab M for iPhone 6 Plus (with or without Rugged Case).

### CHARGE STATUS

The Infinea® Tab M for iPhone 6 Plus Charging Station (1-Unit) uses the following LEDs to indicate the charge status:

STATUS INDICATOR LEDS	
Green	Inserted device is fully charged or charging bay is empty.
Orange	Charging in progress for inserted device.

### TROUBLESHOOTING

**The LED does not come on when the Infinea Tab M for iPhone 6 Plus is placed in the charger slot.**

- Ensure that the USB cable is securely inserted into the USB port on the charging station and connected securely into an appropriate external power supply.
- Ensure the unit is seated properly in the charging bay

**It takes an excessive amount of time to fully charge the battery.**

- Verify ambient temperature meets the operating temperature requirements  
**Operating:** 0° to 40°C (32F° - 104°F)

