

**NFDA**NATIONAL  
FUNERAL  
DIRECTORS  
ASSOCIATION

# MUST SEE PRODUCTS & SERVICES AT THE 2019 NFDA INTERNATIONAL CONVENTION & EXPO

## GOING TO THE NFDA INTERNATIONAL CONVENTION & EXPO?

The following "Must See Products and Services" section highlights companies and their products and services that will be exhibiting at the NFDA International Convention & Expo on October 27-30, 2019 at McCormick Place in Chicago, Illinois. Information has been supplied by the manufacturers serving the funeral industry.

### Sarcophagus 24K Gold Bronze Cremation Urn



This stately urn is truly one of a kind. Unrivalled in quality and craftsmanship, the 24K Gold Sarcophagus has been a top choice for the rich and famous. The Gold-Plated Sarcophagus is made of solid cast bronze and then plated with 24K Gold by skilled artisans in the USA. This urn is undoubtedly in a class of its own and is perhaps the most distinguished cremation option available.

**Visit Us! Booth #168**

Church & Chapel Metal Arts, Inc.  
800-992-1234  
Info@church-chapel.com  
www.church-chapel.com

### Preview™ Alternative Container Viewer

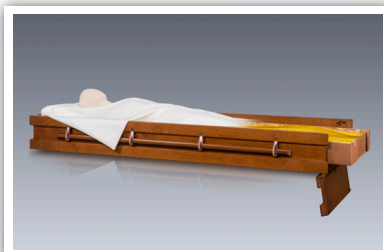

Starmark Cremation Products has taken the lid off cremation services with their new Preview™ solid wood alternative container viewer. Available in multiple finishes, the Starmark Preview is positioned as an affordable container for private viewings. This innovative product is not intended to replace ceremonial rental caskets, but to offer a minimal service option to those families trending towards direct cremation.

**Visit Us! Booth #531**

Starmark Cremation Products  
888-366-7335  
www.starmarkcp.com  
sales@starmarkcp.com

### Bamboo Cremation Container



Bamboo Cremation Containers from Passages International allow you to offer families something more dignified and respectful than cardboard for their loved one in your entry-level or economy cremation packages. Beautifully hand-woven and certified Fair Trade, families will know that they are leaving a lighter footprint with this final decision, while your funeral home will see increased profits and an elevated customer experience.

**Visit Us! Booth #576 & #581**

Passages International, Inc.  
www.passagesinternational.com  
505-830-2500  
info@passagesinternational.com



## American Crematory's AC-1 Cremator Charger



American Crematory's cremator charger is designed with health and safety in mind to allow for single-person, unassisted operation, while minimizing the risk of physical and repetitive strain injuries. One-of-a-kind, cost efficient docking station provides unique compatibility with your crematorium ensuring optimum, efficient, and safe charging. The auto charging system's rapid charge speed offers improved dignity for the deceased over manual charging.

**Visit Us! Booth #602**

**American Crematory**  
562-926-2876

britnie@americancrematory.com  
www.americancrematory.com

## Pitbull Dog Memorial Urn



One of the unique features of this beautifully crafted sculptural design, is to offer customers an option of attaching their dog's existing name tag to truly customize the urn and thus commemorate their beloved companion forever.

With the ample capacity of 90 cubic inches, the Pitbull dog can serve as an urn itself.

**Visit Us! Booth #678**

**Timberland Urns**  
651-688-0875

customerservice@timberlandurns.com  
www.timberlandurns.com

## Management Software Suite



Hyper-focused on single point entry, SRS Computing products are seamless for one-site to multi-location funeral, cemetery and crematory corporations. Turn to the industry leader in sophisticated management software solutions to manage all cases. Take care of families 24/7 with SRS Websites. Process payments and insurance assignments with E-Pay. Track calls with Bar Code. Put your business in your pocket with mobile.9. With 20 years of experience supporting over 5000 locations, SRS has maintained a progressive reputation built from cutting-edge technology.

**Visit Us! Booth #870**

**SRS Computing**  
800-797-4861

ksimons@srscomputing.com  
www.srscomputing.com

## Remote Attendance Solution

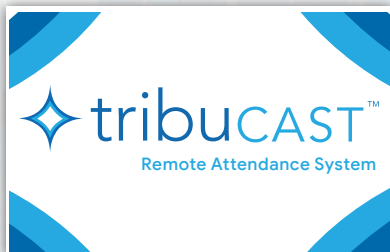

The TribuCast™ remote attendance system offers more than traditional live streaming because a funeral service is accessed through a private website accompanied by highly personalized interactive content that puts the life that was lost into context. For more information contact a TribuCast Advisor at (800)782-0104 or visit TribuCast.com. Watch a demonstration and enter to win a free TribuCast iPad system.

**Visit Us! Booth #871**

**TribuCast™**  
800-782-0104  
info@TribuCast.com  
www.TribuCast.com

## The Everdays App

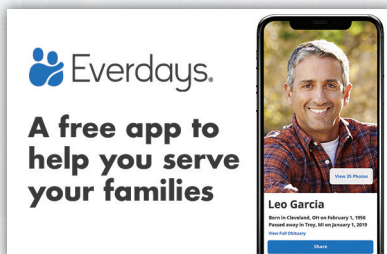

In just 2 minutes, create a dedicated Everdays Page for your families to easily share via text after a passing.

Help your families:

- Broadcast service details & updates
- Send & receive private condolences
- Share photos & memories
- Honor their loved one with a memorial video

Help your home:

- Increase positive customer experience
- Generate 5-star Google reviews
- Receive reminders to check in

**Visit Us! Booth #930**

**Everdays**  
248-480-2444  
Everdays.com  
customersuccess@everdays.com

## Aquamation Systems



Offer your families a gentle alternative to flame cremation. Aquamation (Alkaline Hydrolysis) uses 95% water and 5% alkali to reduce the body to final mineral remains. Families are grateful to receive 20-30% more ashes. Pictured left is our pet system, pictured right is our human system.

Come see both our machines live and in person at booth #980.

**Visit Us! Booth #980**

**Bio-Response Solutions**  
317-386-3500  
info@bioresponsesolutions.com  
www.bioresponsesolutions.com



## Amazing Amp



**TRY IT RISK FREE FOR A MONTH!**  
The Amazing Amp is a 5-pound all-in-one PA system that can do everything a Funeral Director needs. Stop carrying around a bulky back-braking system with trip Hazard wires running everywhere! Amazing Amp is **PORTABLE**. Everything comes in the carrying case. Amazing Amp is **POWERFUL**. You can speak to 400 people indoors or 150-200 people outdoors with one small speaker! Amazing Amp is **PROFESSIONAL**! Crystal-clear sound with everything you need to be heard.

**Visit Us! Booth #1035**

**Empower Sound**  
800-123-4567

[brian@empowersound.com](mailto:brian@empowersound.com)  
[www.empowersound.com/nfda.html](http://www.empowersound.com/nfda.html)

## Digital Registry



Digital registry is growing in popularity with funeral homes and the families it helps. A Simple Thank You has been a leader in this technology and we have added many new features due to requests from funeral directors. New features include; a Floral App to easily add flower pictures to your memorial book, mobile sign in for your guests, and 13" iPad Pro support! This technology is a huge boost in your preneed program capturing all the information needed to reach out to families looking for preneed options. Ask us how to receive **FREE** start up equipment.

**Visit Us! Booth #1058**

**A Simple Thank You**  
800-483-0671

[info@asimplethankyou.com](mailto:info@asimplethankyou.com)  
[www.asimplethankyou.com](http://www.asimplethankyou.com)

## Stars & Stripes Orb



Our "Stars & Stripes" design was created with the mission to honor, respect and forever memorialize everyone who loves our country – everyday Americans and service personnel alike. This memorial keepsake is for all who have sacrificed to make our country a better place, whether in an official capacity or as an everyday citizen. It is for all Americans that have a great love our country and is dedicated to the spirit of freedom. Come see for yourself!

**Visit Us! Booth #1159**

**Memory Glass**  
805-682-6469

[info@memoryglass.com](mailto:info@memoryglass.com)  
[www.memoryglass.com](http://www.memoryglass.com)

## Premium Framed Canvas Portraits



Professionally edited portraits delivered as premium framed canvas and JPEG. Flat-rate price includes photo service, canvas print, frame and priority shipping. Our skilled digital artists will create a beautiful portrait and provide a proof within 24-hours. Upon approval, we print and frame in handcrafted Italian wood. Your canvas portrait is shipped priority service from a facility nearest to you to ensure on-time arrival for the service. The photo editing, canvas print, frame, and priority shipping are included for one flat-rate price.

**Visit Us! Booth #1183**

**MemorialPhotoCanvas.com**  
US & Canada: 888-240-1170  
International: +1 818 357-5890  
[support@memorialphotocanvas.com](mailto:support@memorialphotocanvas.com)  
[www.MemorialPhotoCanvas.com](http://www.MemorialPhotoCanvas.com)

## SuperNova Cremation Package



We're here to help you simplify your cremation memorial product offerings with Supernova's all-inclusive cremation package. Providing you with all the tools you need, including a full product display and video, a selection of brochures and posters, and easy ordering. We streamline how you counsel families on memorialization options while showing you how to embrace cremation in your funeral home.

**Visit Us! Booth #1234**

**SuperNova International**  
800-585-8617  
[admin@supernovaintl.com](mailto:admin@supernovaintl.com)  
[www.supernovaintl.com](http://www.supernovaintl.com)

## LoveUrns® Blessing™ Series



On popular demand we have launched new color in our best selling Blessing™ Series.

Smooth hand-applied pearlescent Lavender finish, adorned with beautiful hand engraved band around the lid of the urn.

A serene combination of Lavender & Silver makes it stunning!

**Visit Us! Booth #1266**

**LoveUrns®**  
888-910-7860  
[mail@LoveUrns.com](mailto:mail@LoveUrns.com)  
[www.LoveUrns.com](http://www.LoveUrns.com)



## Remembrance Registry System

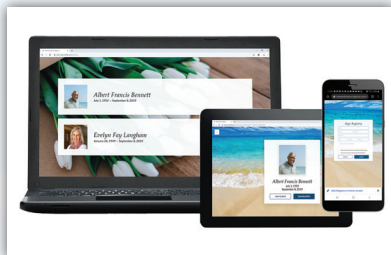

Bass-Mollett will be debuting their new digital registry system at NFDA! It's 100% cloud-based, performs on any platform (computer, tablet, phone) and lets guests sign in from their mobile devices--no more standing in line! It's fully-integrated into Director's Print Suite. In addition to capturing leads, the built in digital registry dashboard reviews guests, generates condolence labels, exports to a CRM and much more. Stop by our booth for a demo and a free snowflake ornament.

**Visit Us! Booth #1312**

**Bass-Mollett**  
800-851-4046  
[www.bass-mollett.com](http://www.bass-mollett.com)  
[www.directorsprintsuite.com](http://www.directorsprintsuite.com)  
[www.promoplace.com/bass-mollett](http://www.promoplace.com/bass-mollett)

## America's Leading Bio Urn



The Patented Living Urn is America's first and leading bio urn and planting system designed to grow a tree memorial. This proven system comes with 2-4 foot trees (not seeds or tiny seedlings) and was developed with professional arborists and soil scientists to help ensure successful outcomes for the families you serve. Visit our exhibit for a special show promotion!

**Visit Us! Booth #1372**

**The Living Urn®**  
800-495-7022  
[mark@thelivingurn.com](mailto:mark@thelivingurn.com)  
[www.TheLivingUrn.com](http://www.TheLivingUrn.com)

## The DD2000-XLC Double Deck System



The DD2000-XLC double deck system safely transports standard and oversized cots side-by-side, four stretchers, four cremation containers, two air trays, or two caskets. The powered upper deck with safety latch raises and lowers within seconds, allowing one person to easily load and transport. The DD2000-XLC system fits inside a majority of full-size cargo vans.

**Visit Us! Booth #1433**

**Link CMP**  
800-248-3057  
[info@linkmfg.com](mailto:info@linkmfg.com)  
[www.linkcmp.com](http://www.linkcmp.com)

## Crematory Management Software



Halcyon Death Care Management Solutions is excited to offer the next generation in human and pet crematory management! The system is fully cloud based, operating system independent, and cross-device compatible. Access your information anywhere from any device. QR (Quick Response) code body tracking enables detailed chain of custody which minimizes liability and our secure portal allows for easy collaboration with your partners.

**Visit Us! Booth #1523**

**Halcyon Death Care Management Solutions**  
770-877-1158  
[sales@halcyondcms.com](mailto:sales@halcyondcms.com)  
[www.halcyondcms.com](http://www.halcyondcms.com)

## Honoring Service VersoTables



The Honoring Service VersoTable sets up in seconds and weighs just 8 pounds! Made from virtually wrinkle-free fabric, each table is portable and designed for use at the church, funeral home or cemetery.

Each table comes standard with patches for Air Force, Army, Marines, and Navy. Additional patches for Coast Guard, first responders, religious affiliation, or other social/civic groups are available.

**Visit Us! Booth #1616**

**Final Embrace**  
800-896-0598  
[www.finalembrace.com](http://www.finalembrace.com)  
[finalembraceonline@gmail.com](mailto:finalembraceonline@gmail.com)

## The Stepper®



The Stepper®, an electric dolly, was designed specifically for the funeral industry for home removals. It electrically climbs and descends stairs with a load up to 375lbs eliminating the need to manually lift and lower. Navigating tight cluttered homes or narrow hallways is a breeze. Less staff is needed and The Stepper® makes injury and frustration a thing of the past.

**Visit Us! Booth #1668**

**Mortuary Lift Company™**  
319-364-4910  
[info@mortuarylift.com](mailto:info@mortuarylift.com)  
[www.mortuarylift.com](http://www.mortuarylift.com)



## AP Lazer Machine

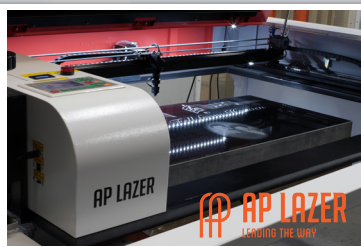

Turn urns, caskets, tribute memorials, pet memorials, keepsake gifts and more into priceless treasures families will cherish forever. AP Lazer's patented design will give your funeral home the edge needed when it comes to personalization and standing out from your competitors. See AP Lazer in action at booth #1766 to learn how you can double your profits while growing your business with AP Lazer by your side.

**Visit Us! Booth #1766**

**AP Lazer**  
800-585-8617  
Info@aplazer.com  
www.aplazer.com

## Custom, Personalized, Handcrafted Obituaries & Eulogies



Beloved is a team of professional writers creating custom, personalized, handcrafted obituaries and eulogies. No templates. No recycling. We partner with funeral homes and enhance their services by providing a story which will be forever remembered. Our process is easy, smooth, and seamless, and our writers are trained in client relations in order to work meaningfully, effectively, and efficiently, with funeral home clientele.

**Visit Us! Booth #1843**

**Beloved**  
248-894-7076  
petra@beloved-press.com  
www.beloved-press.com

## Turnkey Metal Building Option

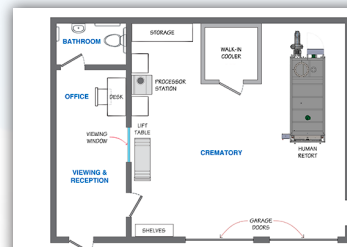

Generally; a 30' x 40' crematory office floor plan can accommodate a Human and Pet retort or two Human chambers. Site conditions and utility access can be variable, but a 1,200 ft2 crematory typically will cost \$60,000. Cremation Systems normally delivers a Human retort and accessories, installs the equipment, fires the chamber, and trains your cremationists, for approximately \$135,000. \*Metal building supplied and installed by others.

**Visit Us! Booth #1871**

**Cremation Systems**  
708-339-6810  
tom@cremsys.com  
www.cremsys.com

## Mobi Embalming Station



The Mobi Embalming Station is constructed with 304 stainless steel and includes a large sink basin, hydro aspirator, and hot and cold water mixing faucet. Other specific features include:

- Floor Stand or Wall-mountable
- Hot and cold water mixing faucet on top with tall spout
- GFCI receptacle
- Optional eyewash attachment available
- Cold water spray hose with spray nozzle

Quick Production/Turnaround Time.  
5-6 weeks. Made in USA.

**Visit Us! Booth #1971**

**Mobi Medical**  
803-758-1001  
tom@mobimedical.com  
www.mobimedical.com

## Roller Bar Storage Racks



- Made in USA
- Military Grade Welded Steel Frame Construction
- Side Loading or End Loading
- Break Apart / Knock Down Design
- Custom Sizes Available

**Visit Us! Booth #1971**

**Mobi Medical**  
803-758-1001  
tom@mobimedical.com  
www.mobimedical.com

## Mobi Battery Operated Crematory Scissor Lift



- Universal Patent Pending Top, use as End or Side loading
- Industrial Strength welded steel construction
- Push button Hand-held pendant operation,
- Minimum height of 19", Maximum Height up to 82 Inches
- Easily handles over 1000 lbs.
- Roller Locks secure Top when in motion
- 62.5" X 25" Top Surface
- LCD Digital Scale (optional)
- Customizable
- Proudly made in the USA!

**Visit Us! Booth #1971**

**Mobi Medical**  
803-758-1001  
tom@mobimedical.com  
www.mobimedical.com