

38 Philosopher's Trail, Northgate, Brampton, Peel County, Ontario, Canada, L6S 4C9



Total Area: 1750 sq. ft

1st Floor: 673 sq. ft, 2nd Floor: 1077 sq. ft

Excluded: Storage 79 sq. ft, Garage 203 sq. ft, Utility 149 sq. ft, Walls: 174 sq. ft

Property summary

2 Floors

3 Bedrooms

2 Bathrooms

1 Garages

Home data report

38 Philosopher's Trail, Northgate, Brampton, Peel County,
Ontario, Canada, L6S 4C9

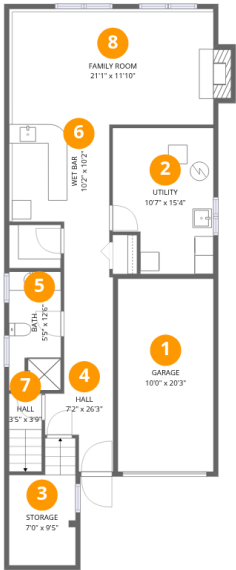

Room dimensions

Floor 1 Total:673sqft Excluded: 431sqft

#		Dimensions	sqft	Counted as living area
1	Garage	10'0" x 20'3"	203 sq. ft	No
2	Utility	10'7" x 15'4"	149 sq. ft	No
3	Storage	7'0" x 9'5"	79 sq. ft	No
4	Hall	7'2" x 26'3"	135 sq. ft	Yes
5	Bath	5'5" x 12'6"	67 sq. ft	Yes
6	Wet Bar	10'2" x 10'2"	107 sq. ft	Yes
7	Hall	3'5" x 3'9"	28 sq. ft	Yes
8	Family Room	21'1" x 11'10"	270 sq. ft	Yes

38 Philosopher's Trail, Northgate, Brampton, Peel County, Ontario, Canada, L6S 4C9

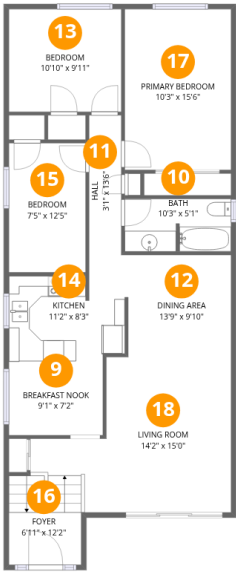

Room dimensions

Floor 2 Total:1077sqft Excluded: 0sqft

#		Dimensions	sqft	Counted as living area
9	Breakfast Nook	9'1" x 7'2"	66 sq. ft	Yes
10	Bath	10'3" x 5'1"	51 sq. ft	Yes
11	Hall	3'1" x 13'6"	42 sq. ft	Yes
12	Dining Area	13'9" x 9'10"	113 sq. ft	Yes
13	Bedroom	10'10" x 9'11"	107 sq. ft	Yes
14	Kitchen	11'2" x 8'3"	83 sq. ft	Yes
15	Bedroom	7'5" x 12'5"	92 sq. ft	Yes
16	Foyer	6'11" x 12'2"	80 sq. ft	Yes
17	Primary Bedroom	10'3" x 15'6"	159 sq. ft	Yes
18	Living Room	14'2" x 15'0"	195 sq. ft	Yes

1 Floor 1 - Garage



Dimensions: 10'0" x 20'3"
Area: 203 sq. ft
Counted as living area: No

Heated: No
Finished: No
Enclosed: Yes
Contiguous: Yes
Permitted: Yes
Wet space: No
Addition: No
Conversion: No

2 Floor 1 - Utility



Dimensions: 10'7" x 15'4"
Area: 149 sq. ft
Counted as living area: No

Heated: Yes
Finished: No
Enclosed: Yes
Contiguous: Yes
Permitted: Yes
Wet space: No
Addition: No
Conversion: No

38 Philosopher's Trail, Northgate, Brampton, Peel County,
Ontario, Canada, L6S 4C9

3 Floor 1 - Storage



Dimensions: 7'0" x 9'5"
Area: 79 sq. ft
Counted as living area: No

Heated: No
Finished: No
Enclosed: No
Contiguous: Yes
Permitted: Yes
Wet space: No
Addition: No
Conversion: No

4 Floor 1 - Hall



Dimensions: 7'2" x 26'3"
Area: 135 sq. ft
Counted as living area: Yes

Heated: Yes
Finished: Yes
Enclosed: Yes
Contiguous: Yes
Permitted: Yes
Wet space: No
Addition: No
Conversion: No

5 Floor 1 - Bath



Dimensions: 5'5" x 12'6"
Area: 67 sq. ft
Counted as living area: Yes

Heated: Yes
Finished: Yes
Enclosed: Yes
Contiguous: Yes
Permitted: Yes
Wet space: Yes
Addition: No
Conversion: No

6 Floor 1 - Wet Bar



Dimensions: 10'2" x 10'2"
Area: 107 sq. ft
Counted as living area: Yes

Heated: Yes
Finished: Yes
Enclosed: Yes
Contiguous: Yes
Permitted: Yes
Wet space: No
Addition: No
Conversion: No

7 Floor 1 - Hall



Dimensions: 3'5" x 3'9"
Area: 28 sq. ft
Counted as living area: Yes

Heated: Yes
Finished: Yes
Enclosed: Yes
Contiguous: Yes
Permitted: Yes
Wet space: No
Addition: No
Conversion: No

8 Floor 1 - Family Room



Dimensions: 21'1" x 11'10"
Area: 270 sq. ft
Counted as living area: Yes

Heated: Yes
Finished: Yes
Enclosed: Yes
Contiguous: Yes
Permitted: Yes
Wet space: No
Addition: No
Conversion: No

9 Floor 2 - Breakfast Nook



Dimensions: 9'1" x 7'2"
Area: 66 sq. ft
Counted as living area: Yes

Heated: Yes
Finished: Yes
Enclosed: Yes
Contiguous: Yes
Permitted: Yes
Wet space: No
Addition: No
Conversion: No

10 Floor 2 - Bath



Dimensions: 10'3" x 5'1"
Area: 51 sq. ft
Counted as living area: Yes

Heated: Yes
Finished: Yes
Enclosed: Yes
Contiguous: Yes
Permitted: Yes
Wet space: Yes
Addition: No
Conversion: No

11 Floor 2 - Hall



Dimensions: 3'1" x 13'6"
Area: 42 sq. ft
Counted as living area: Yes

Heated: Yes
Finished: Yes
Enclosed: Yes
Contiguous: Yes
Permitted: Yes
Wet space: No
Addition: No
Conversion: No

12 Floor 2 - Dining Area



Dimensions: 13'9" x 9'10"
Area: 113 sq. ft
Counted as living area: Yes

Heated: Yes
Finished: Yes
Enclosed: Yes
Contiguous: Yes
Permitted: Yes
Wet space: No
Addition: No
Conversion: No

13 Floor 2 - Bedroom



Dimensions: 10'10" x 9'11"
Area: 107 sq. ft
Counted as living area: Yes

Heated: Yes
Finished: Yes
Enclosed: Yes
Contiguous: Yes
Permitted: Yes
Wet space: No
Addition: No
Conversion: No

14 Floor 2 - Kitchen



Dimensions: 11'2" x 8'3"
Area: 83 sq. ft
Counted as living area: Yes

Heated: Yes
Finished: Yes
Enclosed: Yes
Contiguous: Yes
Permitted: Yes
Wet space: No
Addition: No
Conversion: No

15 Floor 2 - Bedroom



Dimensions: 7'5" x 12'5"
Area: 92 sq. ft
Counted as living area: Yes

Heated: Yes
Finished: Yes
Enclosed: Yes
Contiguous: Yes
Permitted: Yes
Wet space: No
Addition: No
Conversion: No

16 Floor 2 - Foyer



Dimensions: 6'11" x 12'2"
Area: 80 sq. ft
Counted as living area: Yes

Heated: Yes
Finished: Yes
Enclosed: Yes
Contiguous: Yes
Permitted: Yes
Wet space: No
Addition: No
Conversion: No

17 Floor 2 - Primary Bedroom



Dimensions: 10'3" x 15'6"
Area: 159 sq. ft
Counted as living area: Yes

Heated: Yes
Finished: Yes
Enclosed: Yes
Contiguous: Yes
Permitted: Yes
Wet space: No
Addition: No
Conversion: No

38 Philosopher's Trail, Northgate, Brampton, Peel County,
Ontario, Canada, L6S 4C9

18 Floor 2 - Living Room



Dimensions: 14'2" x 15'0"
Area: 195 sq. ft
Counted as living area: Yes

Heated: Yes
Finished: Yes
Enclosed: Yes
Contiguous: Yes
Permitted: Yes
Wet space: No
Addition: No
Conversion: No