

G6502 Installation Manual

INDEX

Read before using

Product features	1
Product specification - exterior trim	2
Product specification - interior trim	5

How to use

Open & lock the door	6
Service features	7

How to install

Door open direction guide and reverse latch	8
Reverse lever handle	9
Assembly illustration	10
Bore hole for lockcase and forend	11
Install the lockcase and spindle	12
Install the trim	13
Install striking plate and striking box	14

Precaution

Functional test and warnings	15
------------------------------	----

**Product features**

NO.	Items	Sub-items	Specification
1	Unlock way	Fingerprint	Capacity: 3 masters + 97 users.
2		Password	Capacity: 3 masters + 47 users.
3		Card	Capacity: 3 masters + 47 users.
4		Remote control	Capacity: 10 users (Customized)
5		Mechanical key	2 Keys
6	Power supply	Working voltage	4 pieces of 1.5V AA alkaline battery
7		Battery life	Under normal usage, 01>2000 times; 02, 03 >3000 times
8		Low voltage alarm	≤4.8V
9		Back-up power supply	5V Micro-USB
10	Power consumption	Quiescent current	≤60uA
11		Dynamic current	01: ≤60uA≤600mA; 02, 03: ≤45uA≤280mA
12	Fingerprint sensor	Scanning area	01, 02 : 12mm×12mm 03: φ13mm
13		Resolution	508dpi
14		Responding speed	<0.5 second
15		Working temperature	-25℃—70℃
16		Relative humidity	20%—95%
17		FRR	≤0.1%
18		FAR	≤0.001%
19		Collecting angle	60°
20		Fingerprint sensor	Semi-conductor
21		Comparison mode	1: N
22		Antistatic ability	≤ air ±15KV contact 8KV
23	Accessibility	Unlock record	50 pieces
24	Door Thickness	Standard lock case 60x68mm/70x68mm	45-110mm, other requirement can be customized.
		Standard lock case 60x85mm/60x72mm	40-110mm, other requirement can be customized.

✓ Product specification - exterior trim (01)

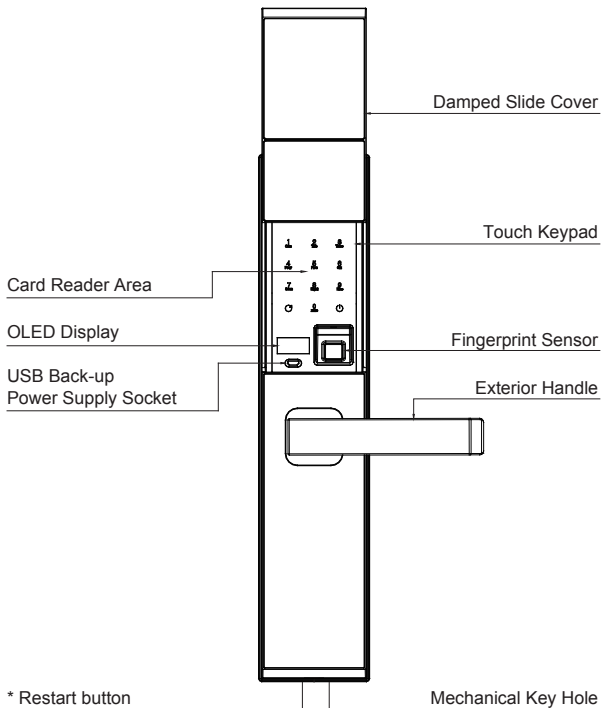

* **Usage of Restart Button:** when lock system fail to operate, press the restart button to restore the lock system for normal usage.

Noted: This operation will not reset the lock system.

✓ Product specification - exterior trim (02)

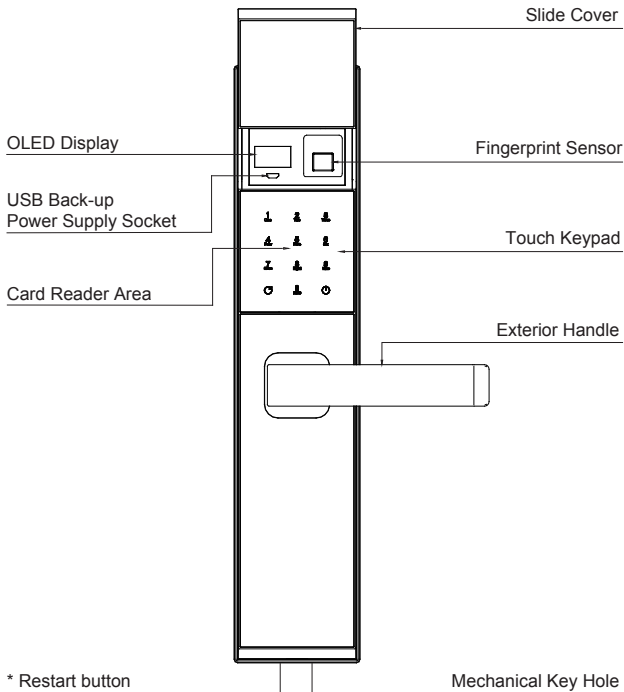

* **Usage of Restart Button:** when lock system fail to operate, press the restart button to restore the lock system for normal usage.

Noted: This operation will not reset the lock system.

✓ Product specification - exterior trim (03)

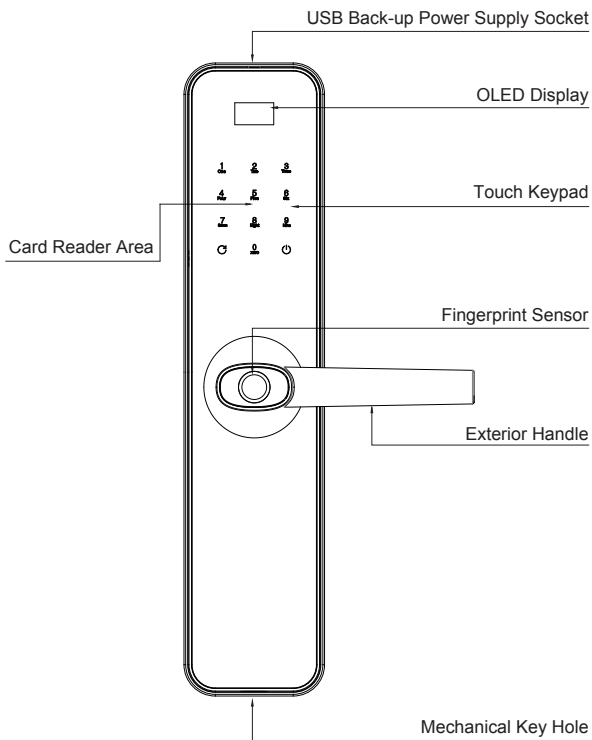

Read before using

✓ Product specification - **Interior trim**

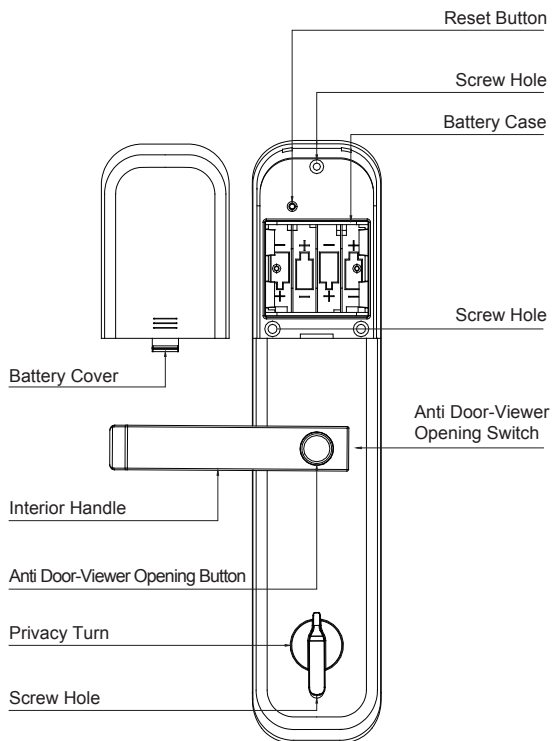

Note: Design of handle on interior trim is different for different model.

Open & lock the door

How to open the door from outside

Fingerprint



for model 01/02



for model 03

1. Place the enrolled finger properly on the fingerprint sensor area.
2. Press down handle to open the door.

Password

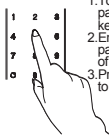

1. Touch keypad by palm to lighten keypad.
2. Enter the enrolled password with end of "←" or "→".
3. Press down handle to open the door.

Card



1. Place the enrolled card properly between number 5 and 8.
2. Press down handle to open the door.

Usage of Mechanical Key

Insert the key into the key hole at bottom of Exterior

Trim and turn it by 90° to unlock the cylinder, then press

down the handle to open the door.

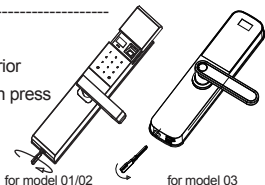

CAUTION

Do not press down the handle while rotating the mechanical key, otherwise, this incorrect operation may get the lock broken. Always rotate the mechanical key first, then press down the handle to open the door.

How to lock the door

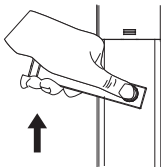

Pull up exterior or interior handle to let the dead bolts come out.

How to open the door from inside

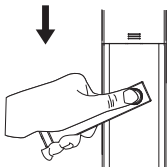

Press down interior handle to open the door.

CAUTION

1. When the Anti Door-Viewer Opening Button is released, please push it down while pulling up the interior handle for letting the dead bolts come out or pressing down the interior handle for opening the door.

2. To disable the Anti Door-Viewer Opening button, please push it down and fix it by the set screw on the side of handle by allen key provided for model 01 and 02, or push down the switch on the side of handle for model 03.



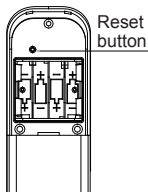

Service features

Restore to factory default settings



Operation instructions :

1. Open battery cover and find the reset button.
2. Press the reset button and keep pressing "  " or "  " on keypad to reset the system.
3. After that all user data and settings will be deleted.

Low power warning and battery replacement

When the battery is lower than 4.8V, there is low power warning signal will appear on the screen. Please replace all batteries immediately. Make sure the battery is installed correctly according to the positive and negative pole.

Emergence power supply

When the battery is too low or completely dead and the lock cannot be opened from outside by inputting master/user identification, connect a 5V power supply via micro USB port on exterior trim. Then unlock the door with master/user identification and replace all batteries immediately.

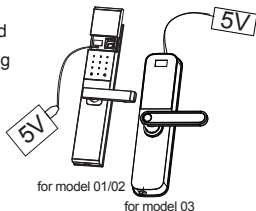

Privacy mode

When door is closed, rotate the thumb-turn to turn on privacy mode.

When the privacy is turned on, only master identifications and mechanical key can open the door from outside. User identifications is prohibited.



- 1.If passage mode is turned on, it will be turned off automatically when privacy mode switched on.
- 2.Please refer to OPERATION INSTRUCTION for the advance setting of passage mode.

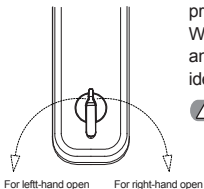

✓ Door-open direction guide

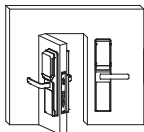

Double door
Left-ward open

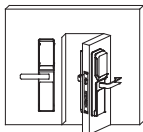

Double door
Right-ward open

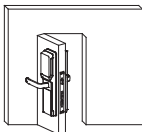

Single door
Left-ward open

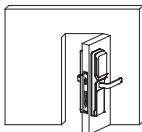

Single door
Right-ward open

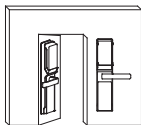

Double door
Left-Inward open

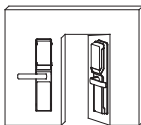

Double door
Right-inward open

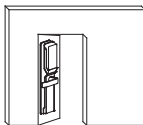

Single door
Left-inward open

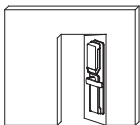

Single door
Right-inward open

✓ How to reverse the latch for inward or outward open door

Unscrew and remove the forend from the lockcase, and then turn the latch by 180° and replace the forend on the lockcase. Finally, fix the forend by screws.

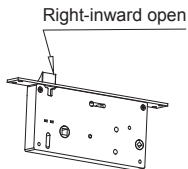
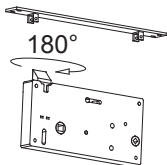
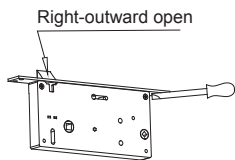

CAUTION

The operation above is for standard mortise lockcase 60x68mm or 70x68mm only.

✓ Reverse exterior lever handle

⚠ CAUTION

Make sure the lock is locked before reversing the lever handle. If you are not sure whether it is locked, please confirm by electrify the lock and pull out the mechanical key.

For model 03:

Reverse the lever handle according to the door opening direction. Release the positioning screw and turn the lever handle 180° from upward (refer to the diagram on the right side). The cam should turn to the side as shown on the diagram.

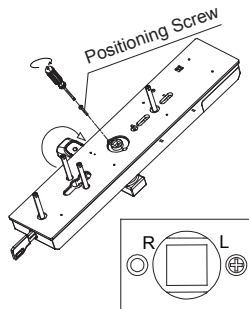

For model 01,02:

Keep pushing the reversing switch outward and turn the handle 180° from downside at the same time to finish reversing direction of the handle.

Noted: When reversing the handle from A side to B side, please push the reversing switch on the A side outward. It is the same way for reversing the handle from B side to A side, which should push the reversing switch on the B side outward; otherwise it is not able to reverse the handle direction.

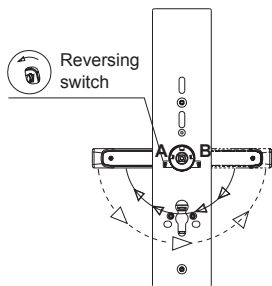

✓ Reverse interior lever handle

1. Loose positioning screw and push the clamp upward.
2. Keep the steering switch to be pressed down and turn the lever handle 180° from upward to reverse the handle.
3. After finish reversing the handle, release the steering switch and replace the clamp and fix it by positioning screw.

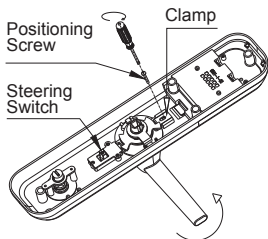

✓ Assembly illustration

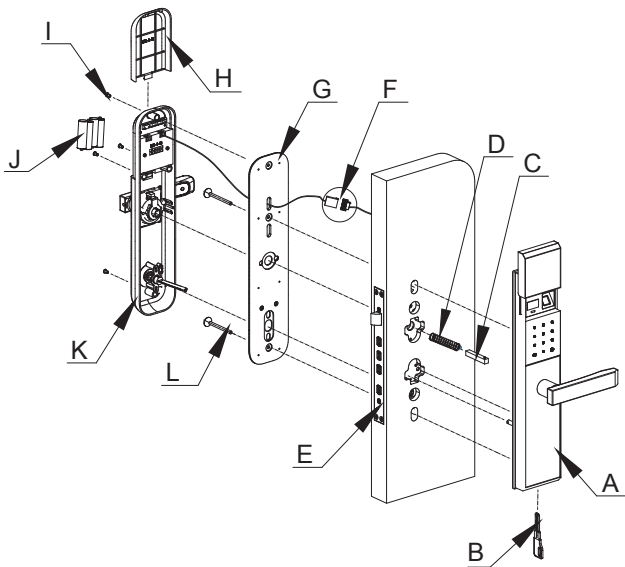

Note: The Diagram is for reference only. Different model has different design of exterior trim.

A. Exterior Trim	D. Spring	G. Base Plate	J. AA Battery
B. Mechanical Key	E. Mortise Lockcase	H. Battery Cover	K. Interior Trim
C. Spindle	F. Wiring Port	I. M4 Screw	L. M5 Screw

✓ How to bore hole for lockcase and forend

On the suitable height (1.0m for reference), mark a reference line and bore holes on door according to the template provided.

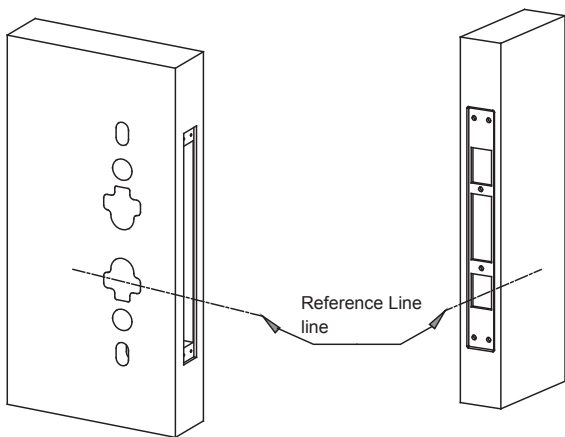

Please refer to the template for trim and mortise lockcase to drill the holes.

Please refer to the template for striking plate to drill the holes

How to install

✓ How to install lockcase

Put the lockcase into the bored hole on door and fix it by screws. Tighten the screws after making sure the forend is flat with the door side.

✓ How to install spindle

Put the spring over the long side of spindle and insert the spindle through the lockcase.

⚠ CAUTION

This product is supplied with two spindles, one is 86mm long and the other is 130mm long. 86mm spindle is suitable to use on door with thickness less than 80mm, 130mm spindle is suitable to use on door with thickness more than 80mm.

Noted: When it is required to cut the spindle shorter for special door thickness, please measure an appropriate length for the spindle and then cut it.

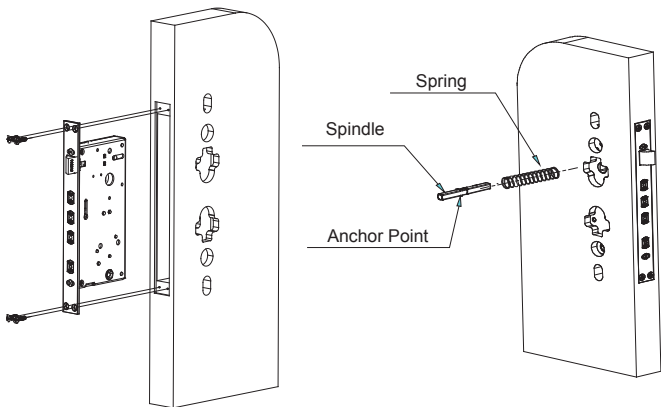

How to install the trim

- Put exterior trim and base plate on each side of the door and use M5 screw to fix it, and then fix the interior trim with the base plate by M4 screw.
- Operate both side of handle and privacy turn to check if the bolts can be extended and retracted smoothly.
- The direction of the privacy turn on interior trim as per diagram 1 for installation.

⚠ CAUTION

Make sure the bolts are retracted into the lock case before installation.

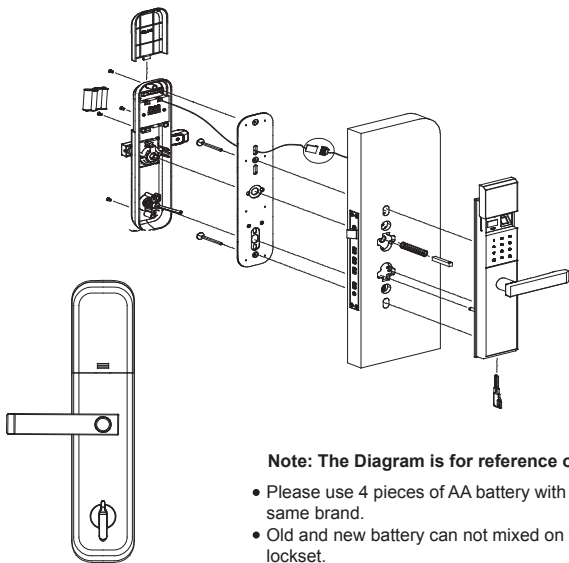

Diagram 1

Note: The Diagram is for reference only.

- Please use 4 pieces of AA battery with same brand.
- Old and new battery can not mixed on this lockset.
- Make sure the battery is put correctly according to the positive and negative pole.

✓ How to install striking plate & striking box

Put the striking box (for wooden door) into the door frame as per diagram.
Install the striking plate and fix it by screws.

Adjust the striking plate if the latch, deadbolt and privacy bolt can not enter into the striking plate smoothly.

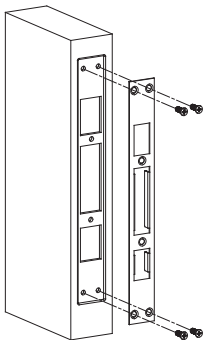

Striking plate for metal door

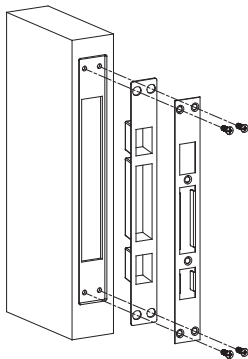

Striking plate for wooden door



Functional test

(CAUTION! PLEASE MAKE SURE THERE IS SOMEONE IN THE ROOM BEFORE THE TESTING COMPLETED.)

1. The lockcase has to be installed firmly. The forend should be perpendicular with the door panel.
2. The exterior trim has to be installed firmly. The side of the trim has to be parallel with the door edge.
3. The deadbolt should be extended for lock when the exterior handle is lifted upward, and it should be retracted for unlock when the handle is able to be pressed down with verification by correct fingerprint, password or card.
4. The latch should be extended and retracted smoothly. When the door is closed, the gap between the door and door frame should be suitable.
5. The deadbolt should be extended and retracted smoothly. When the door is closed, the deadbolt should be able to enter through the striking plate.
6. The privacy bolt should be extended and retracted smoothly. When the door is closed, the bolt should be able to enter into the striking plate by privacy turn.
7. When lifted the interior handle upward with pressing down the anti door-viewer opening button at the same time, the deadbolt will be extended. When pressed down the interior handle and anti door-viewer opening button at the same time, the latch, deadbolt and privacy bolt will be retracted for opening the door.
8. The privacy turn should be as shown on diagram 1 (page 13) when the lock is unlocked. When turn the privacy turn, the bolt should be able to extended and retracted smoothly. When the privacy bolt is extended, the OLED display on the exterior trim should be shown "Locked".
9. Insert the key into the cylinder on the bottom of exterior trim. The key should be able to turn smoothly. When turn the key by 90°, the latch, deadbolt and privacy bolt will be able to retract by pressing down the exterior handle.



Warnings

- * Read and understand all instructions before use.
- * If damage is caused by failure to follow this instructions, the warranty does not apply.
- * Only use the alkaline batteries.
- * Do not expose the product and accessories to rain or water.
- * Do not expose the product to corrosive substances to avoid damage to the protective cover.
- * Do not scrape the fingerprint sensor with any sharp objects, otherwise it may cause permanent damage.
- * When cleaning the product, please wipe with a soft cloth.
- * If there is a low battery alert, please replace all the batteries in time and make sure they are properly installed.

DECLARATION: THE PRODUCT FOLLOWS THE STRATEGY OF SUSTAINABLE DEVELOPMENT. THE COMPANY RESERVES THE RIGHT TO MODIFY AND IMPROVE THE PRODUCT WITHOUT PRIOR NOTICE.