🕒 QUICK MOVE-IN



ELEVATION A

THE ASPEN

113 SHALE STREET (UNIT 523)

**LARGE KITCHEN WITH
WALK-IN PANTRY**

**BASEMENT
ELECTRIC FIREPLACE**

**3 BEDROOM
+ LOFT**



2,246 SQ FT | 3 BED + LOFT | 2.5 BATH

**CARDEL
HOMES**

MAIN FLOOR

803 SQ FT

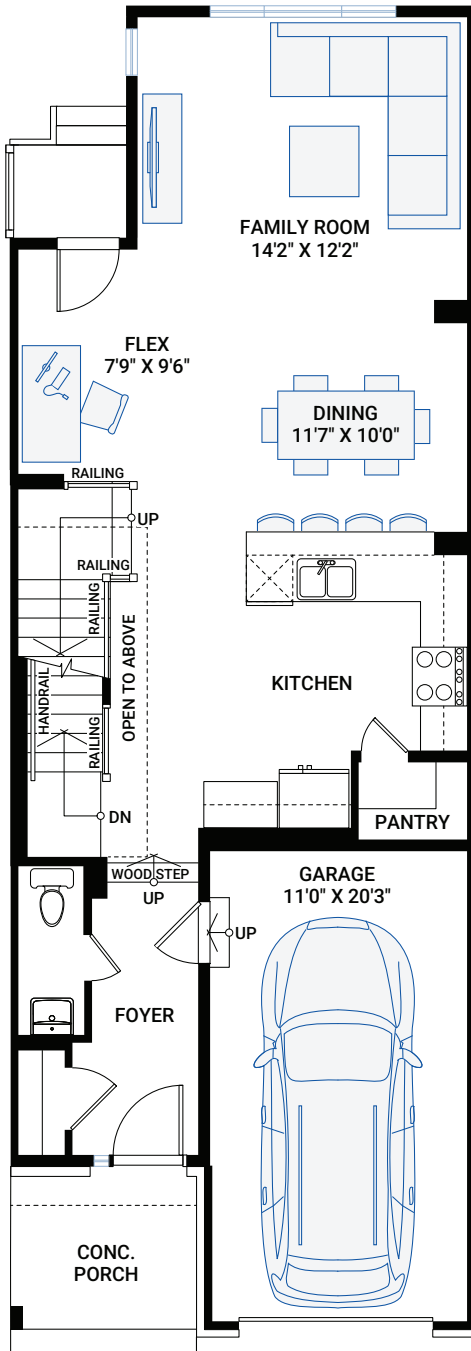

UPPER FLOOR

1,034 SQ FT

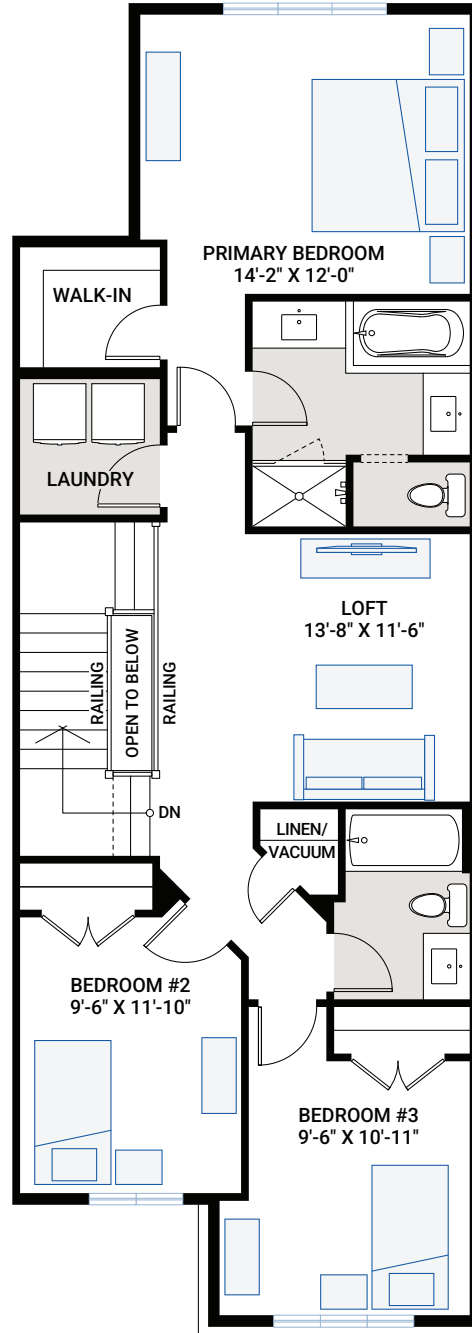

FOR MORE INFORMATION CONTACT: THANG NGUYEN, New Home Consultant
thang.nguyen@cardelhomes.com | P: 343.573.2464



2,246 SQ FT | 3 BED + LOFT | 2.5 BATH



BASEMENT

409 SQ FT

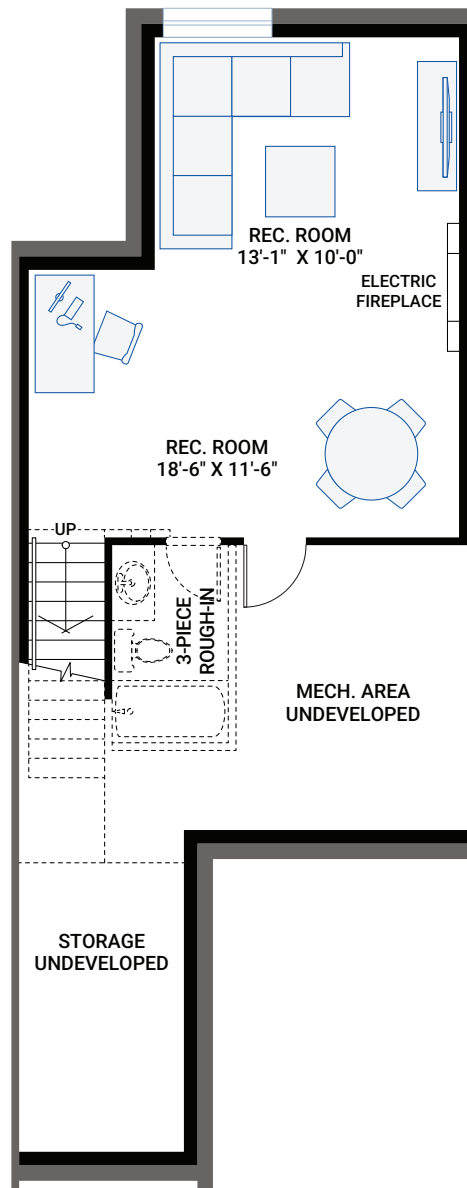

- Open-concept floorplan with main floor flex space
- Alternate main floor with large kitchen peninsula and walk-in pantry
- Upgraded luxury vinyl plank throughout main floor
- Bright interior with Designer selections including;
 - Upgraded white shaker doors throughout
 - Quartz in kitchen, ensuite, and main bath
 - Extended upper cabinets
- Soft close doors and drawers
- Stacked subway tile pattern in kitchen
- Stacked square tile pattern in bathrooms
- 4 LG kitchen appliances included (fridge, stove, dishwasher and OTR microwave)
- Second floor laundry room
- Developed basement rec room with electric fireplace and 3-piece rough-in for future bathroom

INTERIOR COLOUR SCHEME – J



* All sizes are nominal. The colours represented on this page may vary from the actual product colours. Actual samples can be viewed by appointment.