🕒 QUICK POSSESSION



PRAIRIE CL1

Artistic representation only. Actual colours and finishes may vary.

MIDTOWN 1
(PREMIUM PAIRED HOME)

CLEARWATER PARK
326 CLEARVIEW MANOR

1,452 SQ
FT

**SIDE ENTRY TO
BASEMENT**

**QUARTZ
COUNTERTOPS
THROUGHOUT**

**REAR DETACHED
DOUBLE GARAGE**



1,452 SQ FT | 3 BED | 2.5 BATH

CARDEL
HOMES

PLOT PLAN

LANE

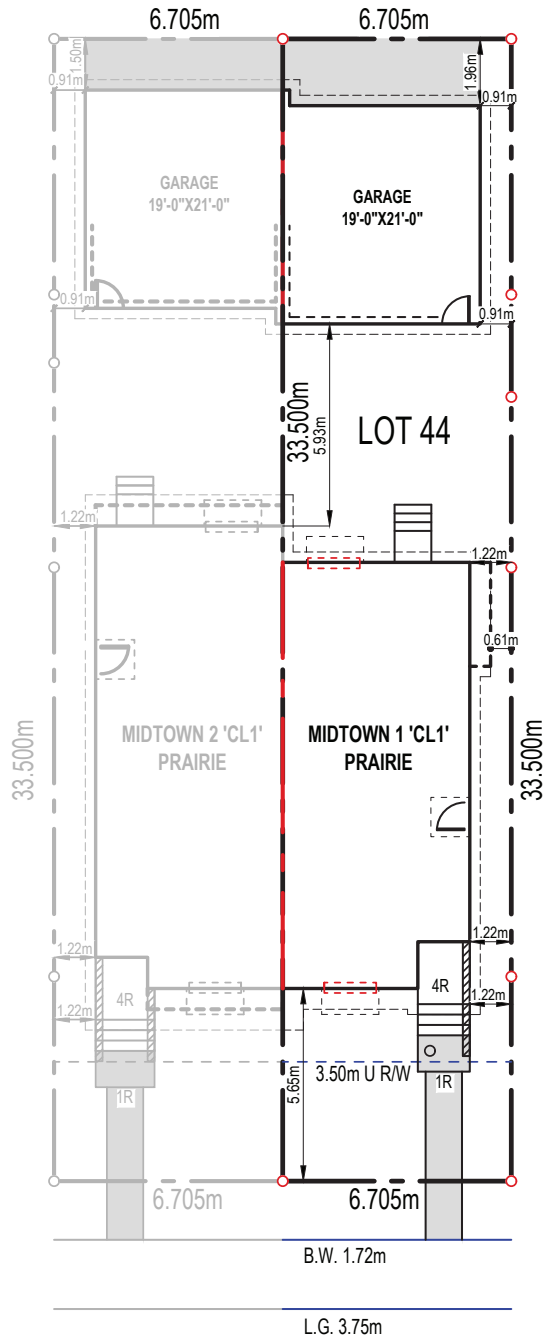

CLEARVIEW MANOR

OUTSTANDING FEATURES

- 9' main floor ceiling
- 9' basement foundation walls
- Separate side entrance to basement
- LVP flooring throughout main floor
- Tile flooring in bathrooms
- Custom cabinetry package including:
 - Soft close hardware
 - Dovetail drawer construction
 - Brushed Nickel hardware
- Stainless steel appliances:
 - Samsung French door counter-depth refrigerator with ice maker
 - Samsung slide in electric range
 - Samsung smart dishwasher
 - Samsung over the range microwave
- Brookmoore stainless steel undermount sink
- Moen Chasen kitchen faucet
- Upgraded wall tile package
- Quartz countertops throughout
- Moen plumbing faucets and fixtures
- Samsung front load washer and dryer
- Heat recovery ventilation system
- Cardel's premium spray foam attic insulation assembly
- Rough-in gas line to kitchen stove and future deck location
- Front yard landscaping
- Fusion Series, black vinyl exterior, maintenance-free, high-performance, triple-glazed windows
- 30-year shingles

INTERIOR COLOUR PALETTE

