

Bottom Mount REFRIGERATOR

SAFETY INFORMATION	2
Grounding requirements	3
INSTALLATION INSTRUCTIONS	6
Before using the refrigerator	4
Find a suitable location	4
Provide appropriate ventilation	6
Access to an appropriate power source	7
Levelling the refrigerator	7
Reversing the door swing	8
USING THE FREEZER	12
Putting the refrigerator into service	12
Using the control panel	12
Selecting a temperature	13
Selecting a freezer temperature	13
Removing fruit and vegetable crispers	14
CARE AND CLEANING	15
Cleaning the refrigerator	15
Defrosting the refrigerator	15
Tips for storing food	16
TROUBLESHOOTING TIPS	18
WARRANTY	22
CONSUMER SUPPORT	23

OWNER'S MANUAL AND INSTALLATION INSTRUCTIONS

MBE19DTNKWW
MBE19DSNKSS

Write the model and serial
numbers here:

Model # _____

Serial # _____

IMPORTANT SAFETY INFORMATION.

READ ALL INSTRUCTIONS BEFORE USING THE APPLIANCE

Introduction

Congratulations on your purchase of this high quality product. These models represent the latest technological breakthrough in the design of bottom-mount refrigerators and have been designed for exceptional performance and reliability.



This symbol indicates that dangerous voltage, constituting a risk of electric shock, is present in this refrigerator.



CAUTION RISK OF ELECTRIC SHOCK DO NOT OPEN

⚠ WARNING

This symbol indicates that important operating and maintenance instructions are included in the documentation accompanying this product.

⚠ WARNING

- Read these instructions.
- Keep these instructions.
- Observe all warnings.
- Observe all instructions.
- Do not use this refrigerator near water.
- Clean only with a damp cloth.
- Do not block the ventilation openings. Install the product in accordance with the manufacturer's instructions.
- Install this appliance away from heat sources such as radiators, heat registers, ovens or other equipment (including amplifiers) that produce heat.
- Do not attempt to modify the safety device of the polarized or grounded plug. A polarized plug has two prongs, one wider than the other. A grounding-type plug consists of two prongs and a third grounding prong. The wide blade or the third blade has been designed for the user's safety. If the supplied plug does not fit into the outlet, have an electrician replace the power outlet.
- Protect the power cord to prevent it from being stepped on or crushed, especially at power outlets, power strips and where it is connected to the refrigerator.
- Do not attempt to modify or extend the power cord of this refrigerator.
- Unplug the refrigerator during thunderstorms or when it will not be used for an extended period of time.
- Make sure that the available AC power supply matches the voltage requirements of this refrigerator.
- Do not handle the plug with wet hands. This will result in risk of electric shock.
- Unplug the power cable by holding the plug, never by pulling the power cord.
- Turn off the refrigerator before disconnecting it.
- All repairs must be carried out by qualified personnel. Have the appliance repaired if it has been damaged, such as damaged power supply cord or plug, liquid entering the refrigerator or falling objects, exposure to rain or water, abnormal operation, or falling.
- To reduce the risk of fire and electric shock, do not expose this refrigerator to rain, moisture, splashes or water drops, and do not place containers filled with liquids on the appliance.
- Do not use an extension cord or ungrounded adapters (two prongs). If the power cord is too short, contact a qualified technician to install an outlet next to the refrigerator. The use of an extension cord can have negative effects on the operation of the refrigerator.
- This equipment is not intended for use by persons (including children) with reduced physical, sensory or intellectual abilities or without experience and knowledge, unless they are under supervision or have been informed about the safe use of the equipment by a person responsible for their safety.
- Children should be supervised to ensure that they do not play with the appliance.
- If the power cord has been damaged, it must be replaced by the manufacturer, its service department or other qualified persons to avoid any danger.

IMPORTANT SAFETY INFORMATION

READ ALL INSTRUCTIONS BEFORE USING THE APPLIANCE

⚠ ELECTRIC SHOCK HAZARD

Failure to comply with these instructions may result in electric shock, fire or fatal injury.

- Keep the ventilation openings of the refrigerator and recess structure clear of obstructions.
- Do not touch the inside of the refrigerator with wet hands. Frostbite could result.
- Do not use any mechanical equipment or other methods to accelerate the defrosting process, other than those specified by the manufacturer.
- Do not damage the refrigerant circuit.
- Do not damage the refrigerant tubing when handling, moving or using the refrigerator.
- Never allow children to play with the refrigerator, operate it or climb into it.
- Do not use household appliances inside the appliance's storage compartments unless they are of the type recommended by the manufacturer.
- Connect only to a drinking water supply.
- Unplug the refrigerator before servicing it.
- If a part or component has been damaged, it must be replaced by the manufacturer, its service department or other qualified persons to avoid any danger.
- Observe local regulations regarding the disposal of the refrigerator due to flammable gases and refrigerants. All refrigeration equipments contain refrigerants that must be removed before disposal. Under federal law it is the consumer's responsibility to comply with federal and local regulations when disposing of this product.
- Do not store explosive substances, such as aerosol cans with flammable propellant gases, in this appliance.
- This appliance is intended for home use and other environments such as:
 - staff kitchen areas in stores, offices and other work environments;
 - on farms and by customers in hotels, motels and other residential environments;
 - bed & breakfast;
 - catering and similar applications other than retail.
- Minimum and maximum water pressure in the tube: 138/827 kPa (20/120 PSIG).

Risk of child entrapment. Before you throw away your old freezer

- Take off the doors.
- Leave the shelves in place so that children may not easily climb inside.

Grounding requirements

This refrigerator must be grounded. This appliance is equipped with a cord having a grounding wire with a grounding plug. The plug must be inserted into an outlet that is correctly installed and grounded.

Incorrect use of the grounding plug can result in a risk of fire or electric shock. Consult a qualified electrician or service person if the grounding instructions are not completely understood, or if doubt exists as to whether your freezer is correctly grounded.

KEEP THESE INSTRUCTIONS

Features

Note: The illustrations in this Owner's Manual are provided for reference purposes only. The actual product may be slightly different.

Product dimensions

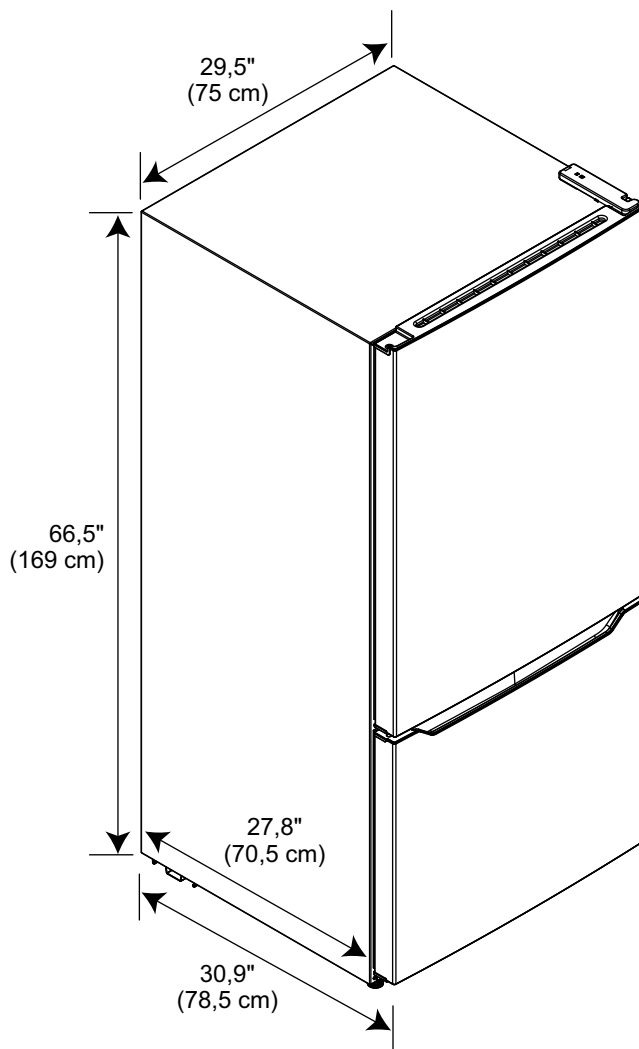

Features

Exterior

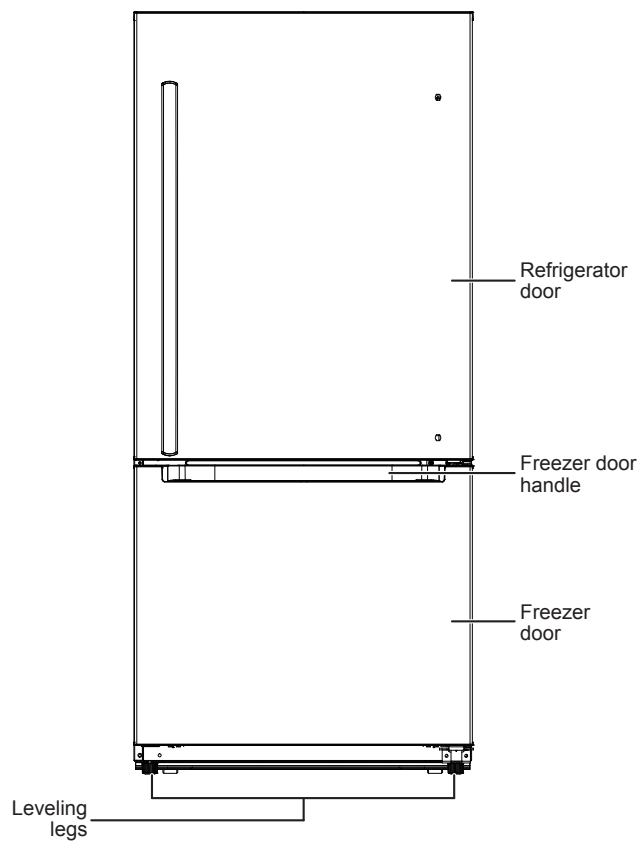

Interior

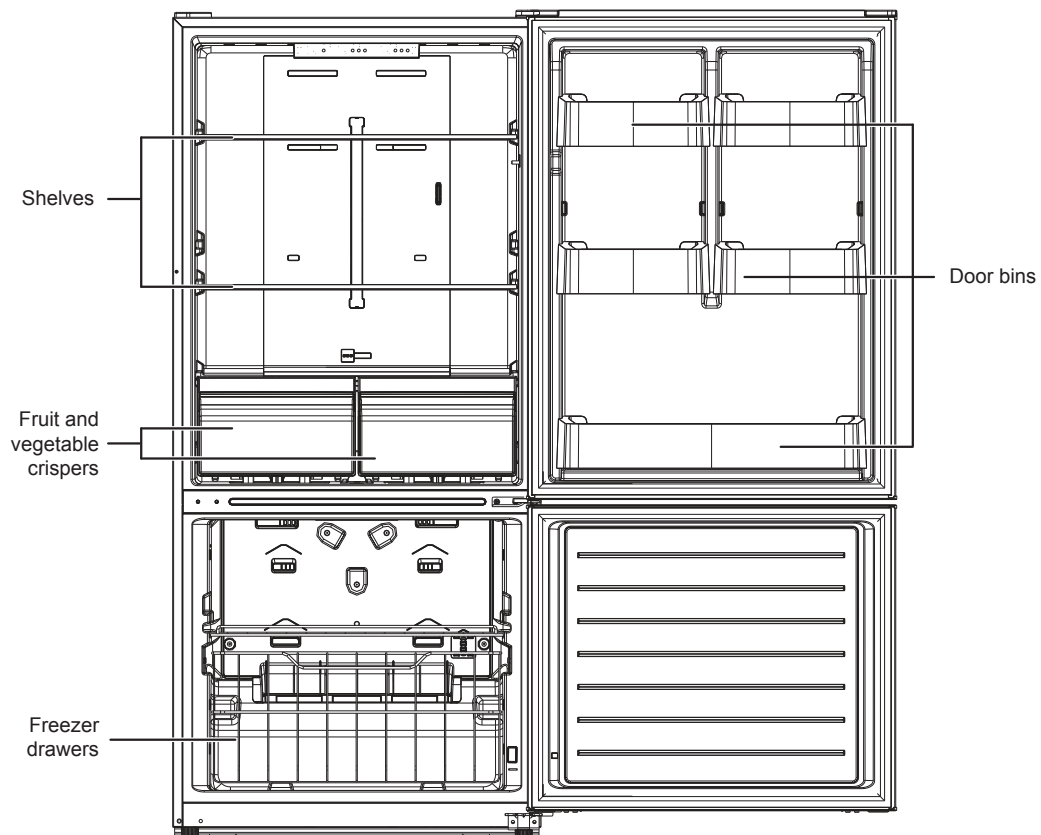

Installation Instructions

Before using the refrigerator

- Remove the outer and inner packaging materials.
- Wash the inside of the refrigerator with a damp warm cloth, soaked in a solution of baking soda (two tablespoons in a quarter of warm water), then dry with a dry cloth. Carry out this cleaning periodically to keep the appliance in new condition.
- Level the refrigerator using the levelling legs. If the refrigerator is not levelled, the doors may not close or be hermetically sealed, which could cause refrigeration, frost or moisture problems. Turn the levelling legs clockwise to raise or counterclockwise to lower one side.

Find a suitable location

- Place the refrigerator on a floor that is strong enough to support it when it is full.
- Do not install the refrigerator on carpet or rugs.
- This refrigerator is designed as a freestanding appliance only and must not be recessed.
- Do not install this refrigerator in a garage or any other outdoor installation.
- Adjust the legs to keep the refrigerator level.
- If the refrigerator is placed near a wall, leave enough space for the hinged part of the door to open without any problem.
- Install the refrigerator away from direct sunlight and other heat sources, such as an oven, heater or radiator. Direct sunlight can damage the acrylic coating and heat sources can increase power consumption. Extremely cold temperatures can also prevent the refrigerator from operating properly.
- Avoid placing the refrigerator in damp places.

This refrigerator has been designed to operate at a temperature between 50°F (10°C) and 109°F (43°C). If the refrigerator operates outside this temperature range, it may not operate properly.

Provide appropriate ventilation

Leave a minimum clearance of 4" (10 cm) between the left and right side walls and the surrounding walls and a minimum clearance of 2" (5 cm) between the top and back of the refrigerator and the ceiling and the surrounding walls.

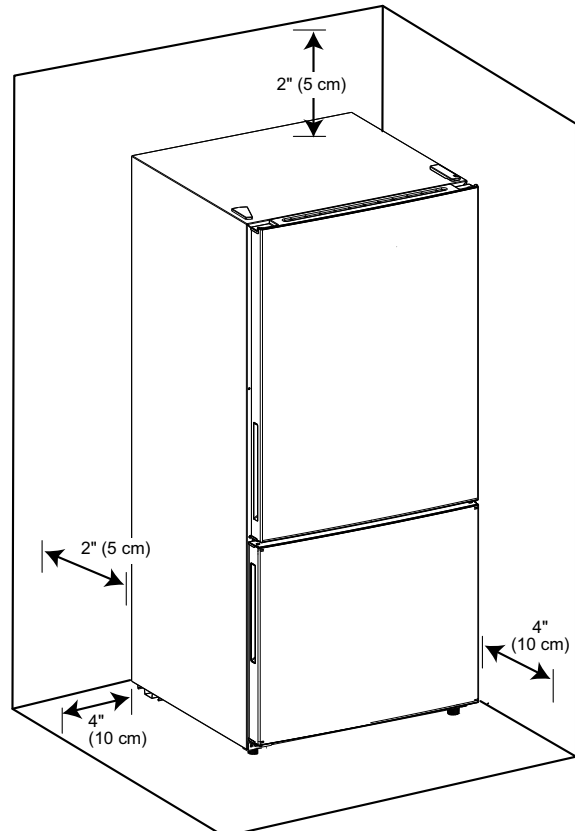

Installation Instructions

Access to an appropriate power source

Check the local power source. This refrigerator requires a 115 V, 60 Hz power supply.

⚠ WARNING

Make sure that:

- The power outlet is suitable for a 3-prong grounded plug. The third prong of the power cord plug grounds the refrigerator to reduce the risk of electric shock. Do not modify the power plug.
- NO other appliance should be plugged into the same outlet as the refrigerator. This could overload the circuit and cause a fire.
- DO NOT use an extension cord. If the refrigerator is too far from a power outlet, move it or ask an electrician to install a grounded outlet closer to it.
- The outlet must not be able to be switched off by means of a switch or cord.

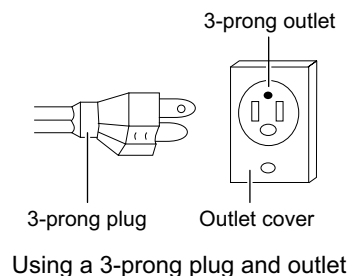

Leveling the refrigerator

Leveling the refrigerator is important. If the refrigerator is not levelled, the doors may not close or be airtight, which could cause refrigeration, frost or moisture problems.

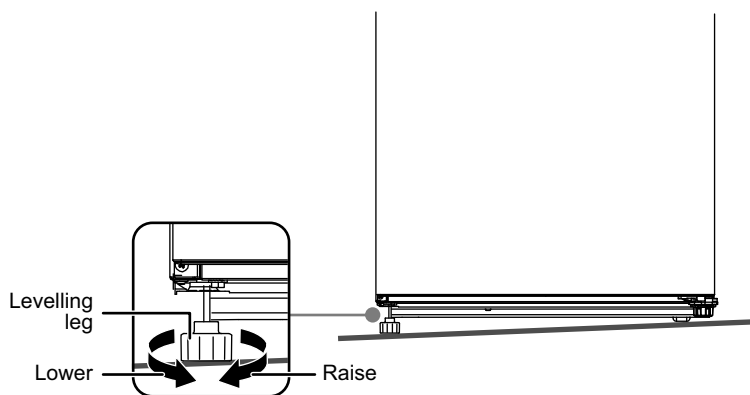

- To level the refrigerator, it is necessary to turn the leveling legs clockwise to raise it, or counterclockwise to lower it.

Note: The legs can be adjusted more easily if another person pushes the top of the refrigerator to tilt it slightly.

Reversing the Door Swing

⚠ CAUTION If the refrigerator is lying on its back or side for a period of time, wait six hours after restoring it to its vertical position to plug it. Otherwise, internal components could be damaged.

The following tools are required to reverse the refrigerator door swing:

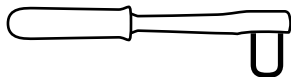

5/16" socket wrench



Phillips screwdriver



Flat blade screwdriver



Masking tape

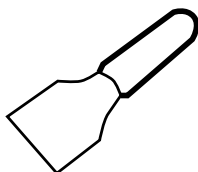

Mastic knife

List of parts provided with the refrigerator:

- Self-locking block on the left side.
- Opening stop on the left side.
- Central hinge on the left side.
- Upper hinge on the left side.
- Upper hinge cover on the left side.

1. Check that the refrigerator is unplugged and empty.
2. Remove the left cover plate and the cover of the upper right hinge, on the top of the refrigerator.
3. Remove the three fixing screws from the top hinge of the refrigerator, then remove the hinge. Keep the screws for later use.
4. Remove the door from the fresh food compartment.

Cover plate

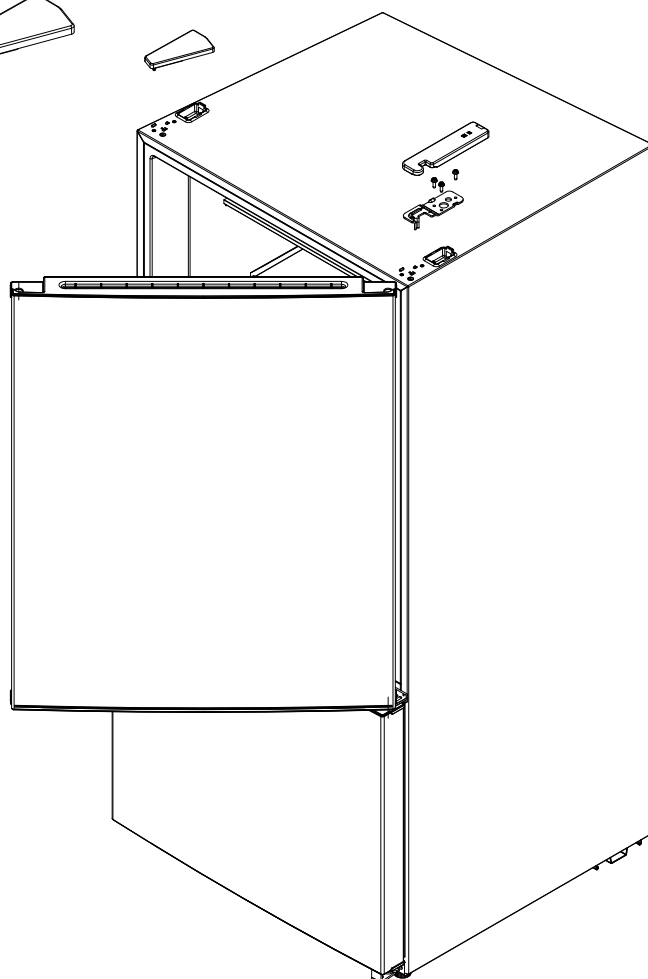
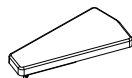

Hinge cover

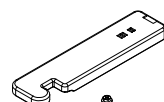

Screws

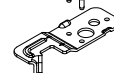

Top hinge

Reversing the Door Swing

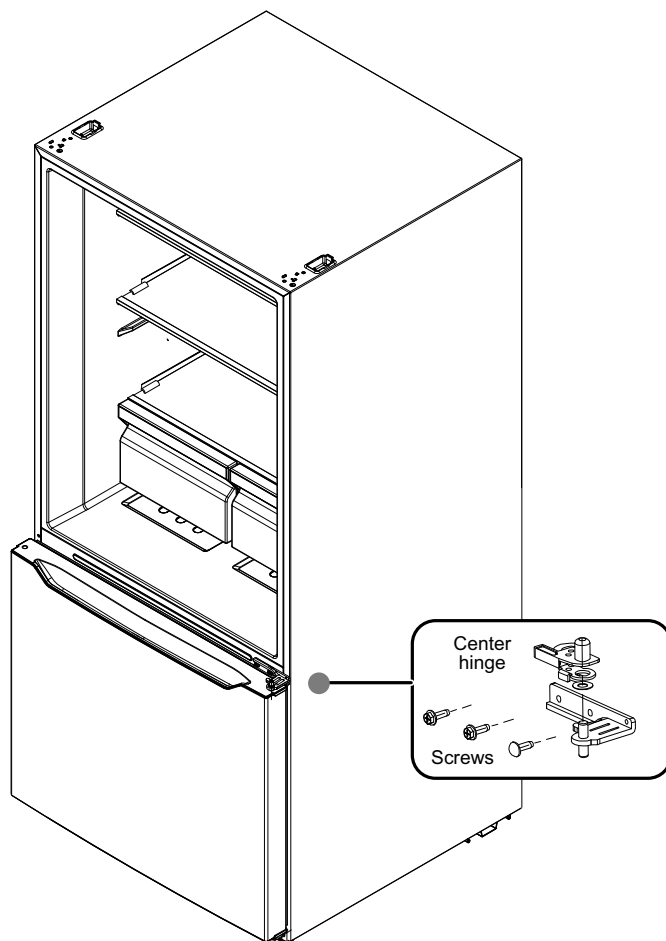

5. Remove the three fixing screws from the central hinge of the refrigerator, then remove the central hinge. Keep the screws for later use.
6. Remove the sleeves and covers from the refrigerator door openings and install them on the other side of the door.
7. Take the self-locking block and stop from the accessory pocket and install them on the lower left side of the refrigerator door as shown below.

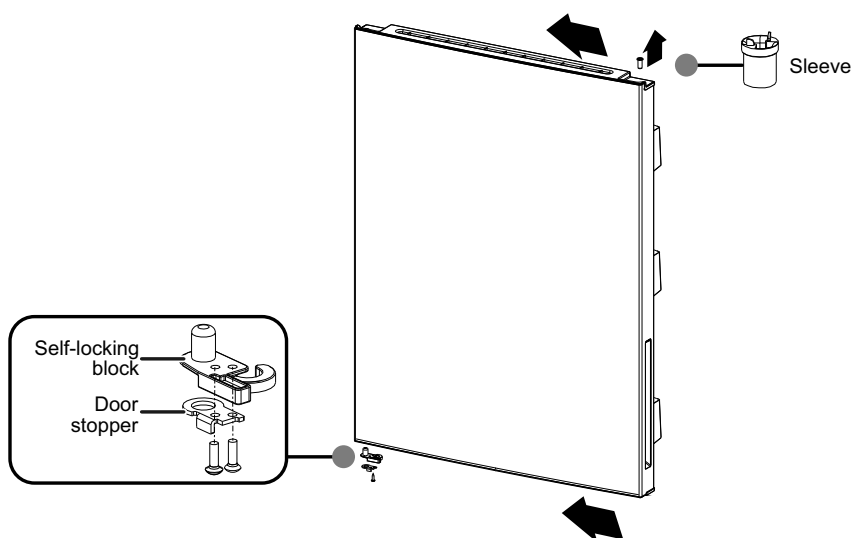

Reversing the Door Swing

8. Take the central hinge on the left side of the accessory pocket and install it on the central left side of the refrigerator with the screws removed previously and the stud of the freezer door sheath. Place the included washer on the upper part of the pin of the central hinge.

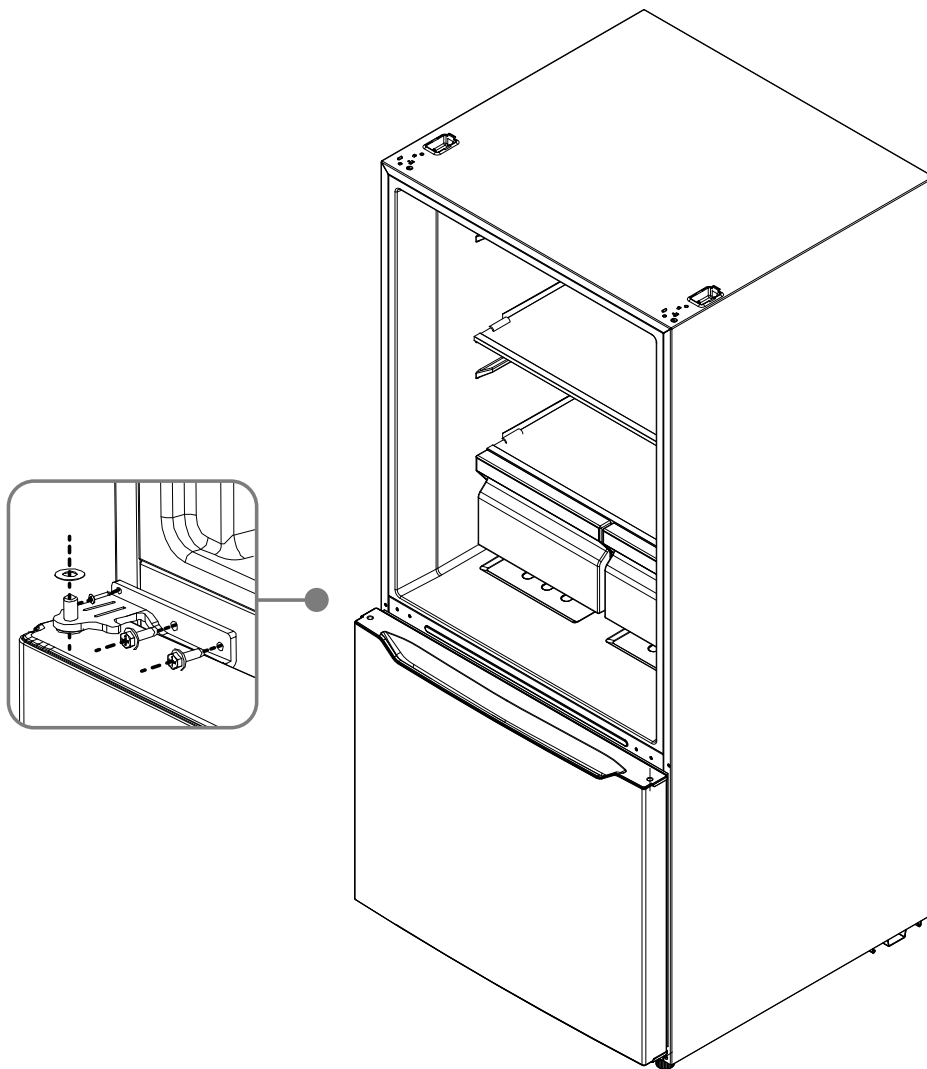

9. Insert the door opening stop on the lower left side of the refrigerator into the hinge pin installed in the centre part of the left side of the refrigerator.

Reversing the Door Swing

- Take the upper hinge from the left side of the accessory pocket and install it on the upper left side of the refrigerator with the screws removed previously and the stud of the refrigerator door sheath.

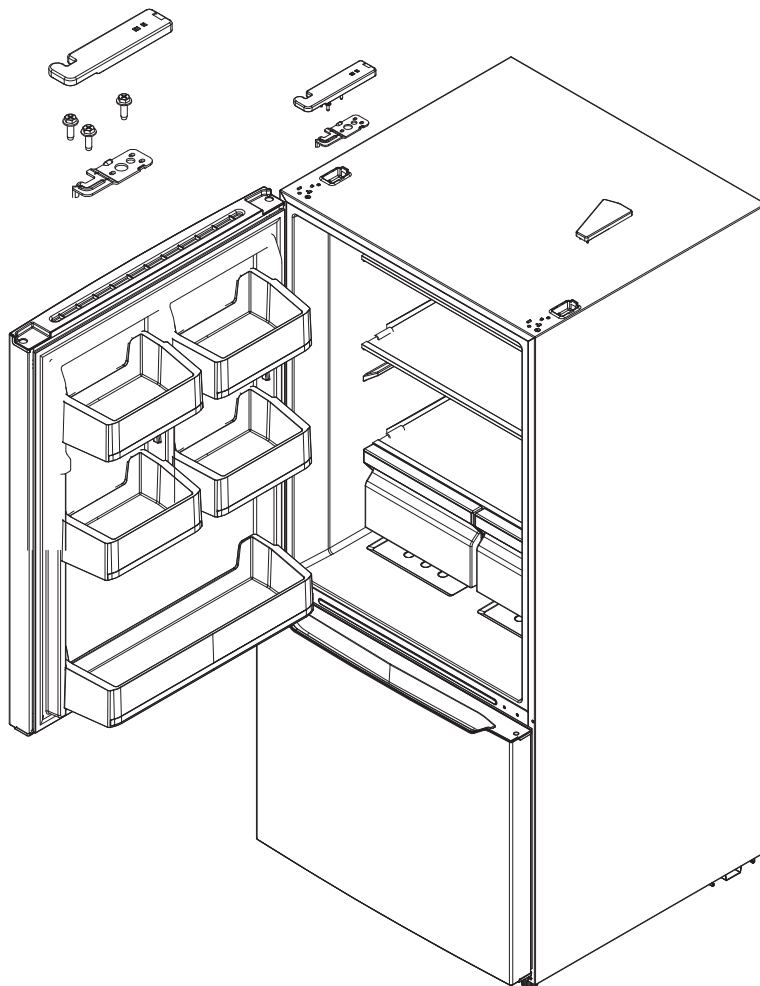

- Install the hinge cover on the left side of the refrigerator and the hole cover on the right side.

Door Handle

Shape of handle may vary on your model.

- Align the handle with fasteners.
- Push the handle over fasteners until it touches the door.
- Use the allen wrench to turn set screw clockwise to fasten the handle to the door.

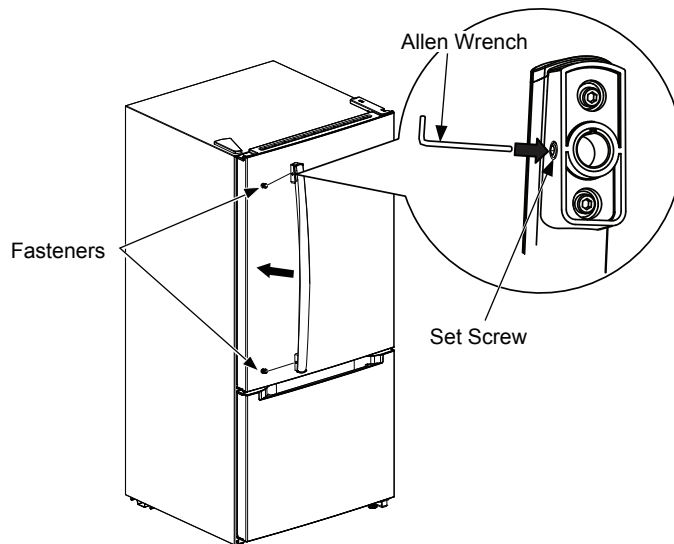

Features

Putting the refrigerator into service

⚠ WARNING

- Internal temperatures may vary depending on the location of the refrigerator, the ambient temperature of the room and the frequency with which the doors are opened.
- Do not store carbonated beverages in the freezer compartment. They could burst and damage the refrigerator.
- Do not exceed the storage period indicated by the manufacturer, regardless of the type of food.

When the refrigerator is first plugged in, the temperature indicator lights up for three seconds, then the refrigerator operates in the default medium setting.

Before storing food in the refrigerator, turn on the refrigerator and freezer compartments and wait 24 hours to make sure they are working properly and to allow both compartments to reach the correct temperatures.

Disabling the open door alarm

When the refrigerator compartment door is open for more than three minutes, an alarm sounds.

Press the ALARM OFF button in the refrigerator compartment to deactivate the alarm.

When the door is closed, the alarm is deactivated.

Using the control panel

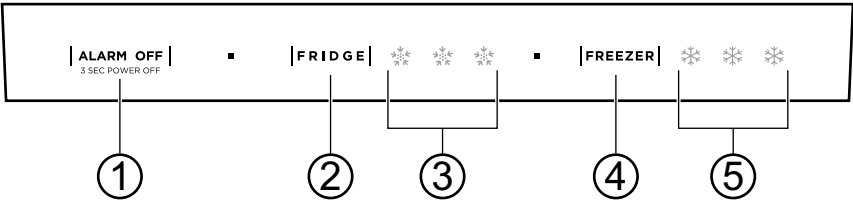

No.	ELEMENT	DESCRIPTION
1	ALARM OFF ON/OFF pad	<ul style="list-style-type: none">■ Allows you to disable the door alarm.■ Press this pad for three seconds to put the refrigerator or freezer in standby mode. Press this button for three seconds to turn the refrigerator or freezer back on.
2	REFRIGERATOR pad	Allows you to scroll through the refrigerator temperature settings.
3	Refrigerator indicators	One to three indicator lights indicate the refrigerator temperature settings. <ul style="list-style-type: none">• One indicator light = 45°F (7°C)• Two indicator lights = 39°F (4°C)• Three indicator lights = 36°F (2°C)
4	FREEZER pad	Allows you to scroll through the freezer temperature settings.
5	Freezer indicators	One to three indicator lights indicate the freezer temperature settings. <ul style="list-style-type: none">• One indicator light = 9°F (-13°C)• Two indicator lights = - 2°F (- 19°C)• Three indicator lights = - 8°F (- 2°C)

Features

STANDBY mode

If the refrigerator compartment is set to STANDBY mode, both the refrigerator and freezer compartments stop cooling. The indicator light in the refrigerator compartment continues to operate.

⚠ CAUTION If the refrigerator compartment is set to STANDBY mode, remove all food from both compartments to prevent food spoiling.

Selecting a temperature

Press the FRIDGE pad to scroll through the refrigerator temperature settings.

A warning light indicates a warm temperature. Three indicator lights correspond to the coldest temperatures.

Determining the best temperature setting

SEASON	RECOMMENDED SETTING
Summer (more than 95°F (35°C))	One indicator light
Spring or Fall (56 to 94°F (13 to 34°C))	One to three indicator lights
Winter (lower than 55°F (13°C))	Three indicator lights

Selecting a freezer temperature

Press the FREEZER button to go through the freezer temperature settings.

A warning light indicates the warmest temperature. Three indicator lights correspond to the coldest temperature.

Determining the best temperature setting.

SEASON	RECOMMENDED SETTING
Summer (more than 95°F (35°C))	Three indicator lights
Fall or end of the year (56 to 94°F (13 to 34°C))	One to three indicator lights
Winter (lower than 55°F (13°C))	One indicator light

Adjusting the refrigerator shelves

The shelves inside the refrigerator and freezer compartment are adjustable.

1. Open the refrigerator or freezer door completely.
2. Lift a shelf and remove it.
3. To replace a shelf, slide it back into the compartment, then lower it to its position.

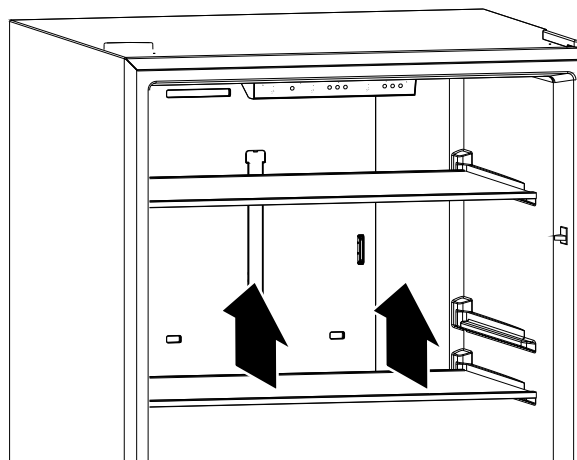

Features

Adjusting the door bins

⚠ CAUTION Do not place too many heavy products in the door bins. This could break the bins.

The fresh food and freezer compartments have bins in the door. It is possible to adjust the bins to fit the stored products.

1. Remove all products from the bins.
2. Hold the door balloon with both hands, then press on the balloon by pushing it up and remove it.
3. Select the desired level to position the balconnet, then press the balconnet down to reinstall it.

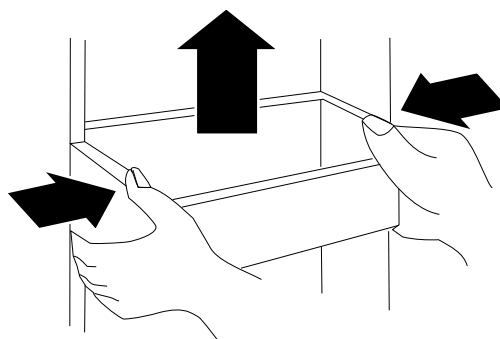

Removing the fruit and vegetable crispers

The vegetable crisper drawer is designed to store fruits and vegetables. Storing fruits and vegetables inside the drawer helps to prevent moisture loss and odours from affecting other foods.

1. Fully open the fresh food compartment door.
2. Remove the vegetable crisper, then lift it up to remove.
3. To replace the crisper, slide the back of the drawer into the opening, then lower the front and push it into the opening.

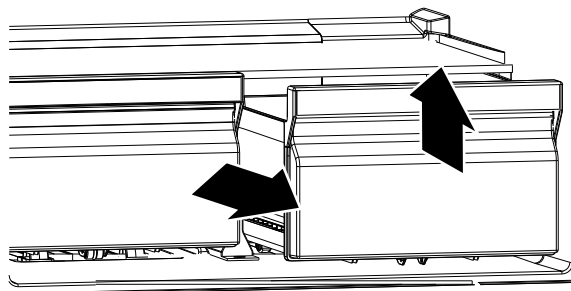

Care and Cleaning

⚠ WARNING

To avoid damaging the finish:

- Do not use gasoline, benzene, thinner or other similar solvents.
- Do not use abrasive cleaners.
- Do not use sharp objects, as they will scratch the surface.

It is recommended to do the following each time the refrigerator is cleaned, so that it operates odourless and efficiently:

1. Unplug the refrigerator from the outlet.
2. Remove all food.
- 3 To remove the door bins, shelves, crisper or freezer bins, refer to :
 - Adjusting door bins on page 14
 - Adjusting fresh food compartment shelves on page 13
 - Removing fruit and vegetable crispers on page 14

4. Clean doors, handles and cabinet surfaces with a mild detergent and rinse with warm water using a sponge or damp cloth.
5. Wash the inside with a damp warm cloth, soaked in a solution made with a quarter of warm water and two tablespoons of baking soda, then rinse with warm water with a sponge or damp cloth.
6. Clean the bins, shelves and drawers with detergent and a soft cloth, then rinse with hot water.
7. Make sure to keep the door seals clean, so that the door closes tightly. This allows the refrigerator to operate efficiently.

⚠ CAUTION

Make sure that the door bins are completely dry before plugging the refrigerator into an AC outlet.

8. Dry all surfaces and removable parts before replacing them.
9. Plug the refrigerator into the power outlet.

Defrosting the refrigerator

This refrigerator is equipped with an automatic defrost system that does not require defrosting. Frost that forms due to seasonal changes can be removed manually by unplugging the refrigerator or wiping the freezer compartment with a dry cloth.

If the refrigerator will not be used for a long period of time (several months)

1. Turn off the refrigerator and unplug it from the wall outlet.
2. Remove all food.
3. Clean the refrigerator.
4. Leave the door slightly ajar to avoid possible condensation, mould or odor formation.

⚠ CAUTION

Be very careful with children. Do not let children play with the refrigerator.

Moving the refrigerator

1. Turn off the refrigerator and unplug it from the wall outlet.
2. Remove all food.
3. Attach all removable parts inside the refrigerator using adhesive tape.
4. Secure door closed with adhesive tape.
5. Ensure that the refrigerator is in its upright position (with a maximum inclination of 45°) during transportation.

Care and Cleaning

Tips to save energy

- Install the refrigerator in the coolest part of the room, away from heat-producing appliances or heating pipes and away from direct sunlight.
- Allow hot food to cool down to room temperature before placing it in the refrigerator. Overloading the refrigerator forces the compressor to run longer.
- Wrap foods properly and wipe containers dry before placing them in the refrigerator. This prevents frost build-up inside the refrigerator.
- Organize and label food to reduce door openings and extended searches.
- Do not use aluminum foil, wax paper or paper towels to coat shelves. Coatings interfere with the circulation of cold air, making the refrigerator less efficient.

Tips for storing food

- Always store cooked meats on a shelf above raw meats to avoid bacteria transfer. Store raw meat on a plate that is large enough to collect juices and cover the plate with plastic film or aluminum foil. Leave space around food. This allows cold air to circulate around the refrigerator, so that all parts of the refrigerator remain fresh.
- To avoid odour transfer and drying food, wrap or cover each food separately. Fruits and vegetables do not need to be packaged.
- Allow hot food to cool down before placing it in the fresh food or freezer compartment. If hot food is placed into the refrigerator, this could affect other foods and generate higher temperatures.
- To prevent cold air from escaping, try to limit door openings. When arriving home with purchases, sort foods that will be stored in the fresh food or freezer compartments before opening the door. Do not open the door except to place or remove food.
- Do not store foods that degrade easily at low temperatures, such as bananas and melons.
- When storing food in the refrigerator, use containers with lids as much as possible. This prevents moisture from evaporating and helps foods retain their taste and nutrients.
- Frozen food must be kept packed with polyethylene film, foil or any other type of storage product in the freezer compartment.
- Do not obstruct the ventilation vents with food in the compartments. A smooth flow of fresh air helps the refrigerator and freezer to maintain stable temperatures.
- Do not open doors frequently. When the door is open, hot air enters the compartments and can raise the temperature.
- To easily adjust the temperature, do not store food near the temperature control pads.
- Never store too much food in the door shelves as this may prevent the door from closing properly.
- Do not store bottles in the freezer. They could break when they freeze.
- Do not freeze food that has already been thawed. This would cause loss of taste and nutritional values.
- Store fruits and vegetables in the crisper to avoid excessive evaporation of water and freshness.
- Leave a small amount of "air space" when freezing liquids to allow them to expand.
- To optimize the freezer space, freeze liquids (or solids with liquid, such as stews) in square spaces. Pour the liquid into a freezer bag placed in a square container and freeze it. When the liquid is frozen, remove the bag from the container and close the bag.

Care and Cleaning

How to buy frozen products

- When purchasing frozen products, check the storage instructions on the packaging. Check the "Best Before" date. Do not use these foods after this date.
- Check the temperature of the frozen food cabinet in the store where the frozen food is purchased.
- Check that the packaging of frozen food is in perfect conditions.
- Always buy frozen products last, to prevent them from thawing during storage.
- Keep frozen food together during shopping and on the way home to keep them cold.
- Do not buy frozen food if it cannot be frozen immediately.
- When transporting frozen food, use special bags that can be purchased in most supermarkets and equipment stores. They allow frozen food to be kept frozen for longer.
- Freeze food in small quantities. They freeze faster and take less time to thaw.
- If freezing large quantities of fresh food, select a low temperature range. This will lower the temperature of the freezer so that food freezes more quickly. When the food is frozen, set the temperature back to normal mode.

Troubleshooting Tips... Before calling for service

Error indication

Note: The LED indicators mentioned here are the snowflakes on the control panel.

If an error is displayed, call the store where the refrigerator was purchased for technical assistance.

⚠ CAUTION User should not attempt to repair this unit himself. This would void the warranty.

Error code	State	Description of the problem
E1	LED 1 and 2 flashing	Error in the refrigerator temperature sensor.
E2	LED 1 and 5 flashing	Error in the freezer temperature sensor.
E5	LED 1 and 3 flashing	Defrost sensor error.
E6	LED 2 and 4 flashing	Communication error.
E7	LED 1 and 4 flashing	Error in the temperature circuit.

PROBLEM	SOLUTION
The refrigerator does not work.	<ul style="list-style-type: none"> ■ Check that the refrigerator is firmly connected to a working power outlet. ■ Check that the voltage of the power source is correct. The voltage of the refrigerator is indicated on the label on the back of the appliance. ■ Check household fuse or circuit breaker box and replace the fuse or reset the circuit breaker.
Fresh food compartment emits a bad smell.	<ul style="list-style-type: none"> ■ Make sure that foods having a strong odor (such as onions) are wrapped and stored in airtight packages. ■ Some containers and packaging materials (such as paper, foil or plastic) can be a source of odors. If this could be the case, try to use containers or packaging materials of a different brand. ■ Check for and remove any spoiled food. ■ Clean the inside of the refrigerator. See Cleaning the refrigerator on page 16.
The refrigerator doors do not close completely.	<ul style="list-style-type: none"> ■ Check that no food packaging interferes with the door closure. ■ Make sure that door gaskets are clean. See Cleaning the refrigerator on page 16. ■ If the door gasket is not tight enough, try heating and then cooling it. It is possible to use an electric hair dryer to heat the gasket. ■ Check that the refrigerator is level. See Refrigerator Leveling on page 9.
The temperature is too high.	<ul style="list-style-type: none"> ■ Doors may have been left open too long or too frequently. ■ Make sure that there are no items preventing the doors from closing properly. ■ Adjust the temperature of the refrigerator or freezer compartments. See Temperature Setting on page 14 or Freezer Temperature Setting on page 15. ■ The refrigerator may not have enough clearances from the walls or ceiling. See Provide appropriate ventilation on page 8.
The temperature is too low.	<ul style="list-style-type: none"> ■ Adjust the temperature of the refrigerator or freezer compartments. See Temperature Setting on page 14 or Freezer Temperature Setting on page 15.

Troubleshooting Tips... Before calling for service

PROBLEM	SOLUTION
A layer of ice forms in one of the compartments.	<ul style="list-style-type: none"> ■ A layer of frost can form on the interior walls of the compartment if the freezer is opened frequently or kept open for too long. ■ Check that air intakes are not blocked by food. ■ Check that the doors are properly closed.
The refrigerator door is difficult to open or close.	<ul style="list-style-type: none"> ■ When the refrigerator door is open, warm air enters. When the door is closed, hot air enters the condenser, creating a vacuum effect. This is why the door is difficult to open for about 10 to 15 seconds after closing. ■ If the door is difficult to open under other conditions, try applying a coat of paraffin or vaseline to the edges of the door gasket. Paraffin is used for canning and can be used safely in the vicinity of food. ■ If it is difficult to close the door, try to loosen the door hinge tension slightly.
The compressor runs for a long time or turns on and off frequently.	<p>The compressor runs longer if:</p> <ul style="list-style-type: none"> ■ The room temperature is high; ■ A significant amount of food has just been added. Wait until the food is frozen and check again; ■ The door is opened and closed frequently; ■ The door gasket is dirty. Clean the gasket. See Cleaning the refrigerator on page 16. ■ The refrigerator has been unplugged for a period of time. Wait until the refrigerator cools down (about four hours) before adding food. ■ The temperature is set too low.
The water tray overflows.	<ul style="list-style-type: none"> ■ There may be too much foods in the refrigerator, or the water content of the food is too high, resulting in significant defrosting. ■ Check that doors are properly closed to avoid thawing inside the refrigerator or freezer.
The refrigerator makes unusual noises or vibrations.	<p>The following sounds are normal:</p> <ul style="list-style-type: none"> ■ Compressor operating noises. ■ Noise caused by the air movement of the small fan motor in the freezer compartment or other compartments. ■ Cracking during automatic defrosting. ■ Clicking noise before the compressor starts. <p>Unusual noises or vibrations may be heard:</p> <ul style="list-style-type: none"> ■ If objects are placed on top of the refrigerator. Remove them. ■ The refrigerator is not level. See Refrigerator Leveling on page 9. ■ If the refrigerator touches the walls. Keep it away from the walls. ■ Check that the shelves or drawers are properly installed.
The exterior of the refrigerator is hot.	<p>Heat dissipation of the capacitor can be responsible for a sensation of heat from the outside. This is normal and occurs if:</p> <ul style="list-style-type: none"> ■ The room temperature is high; ■ Too much food inside the refrigerator. ■ Doors are too frequently opened and closed.
Condensation forms on the exterior surface the refrigerator.	<ul style="list-style-type: none"> ■ Condensation on the exterior surface and the door gasket is normal when the room humidity is high. ■ When the door is open, the heat and humidity from the outside air meets the cold air from inside the refrigerator. This is normal.

Please place in envelope and mail to:
Veuillez mettre dans une enveloppe et envoyez à:

**OWNERSHIP REGISTRATION
P.O. BOX 1780
MISSISSAUGA, ONTARIO
L4Y 4G1**

**(FOR CANADIAN CONSUMERS ONLY -
POUR RÉSIDENTS CANADIENS SEULEMENT)**



For Canadian
Customers



Pour les
Consommateurs
Canadiens

CUT ALONG THIS LINE AND RETURN CARD - THANKS
DÉCOUPEZ ICI ET ENVOYEZ LA FICHE - MERCI

OWNERSHIP REGISTRATION CERTIFICATE – FICHE D'INSCRIPTION DU PROPRIÉTAIRE

Please register your product to enable us to contact you in the remote event a safety notice is issued for this product and to allow for efficient communication under the terms of your warranty, should the need arise.

Veuillez enregistrer votre produit afin de nous permettre de communiquer avec vous si jamais un avis de sécurité concernant ce produit était émis et de communiquer facilement avec vous en vertu de votre garantie, si le besoin s'en fait sentir.

REGISTER ON-LINE: www.geappliances.ca

MAIL TO: **P.O. BOX 1780, MISSISSAUGA**

ENREGISTREMENT SUR INTERNET À : www.electromenagersge.ca

POSTEZ À : **ONTARIO, L4Y 4G1**

<input type="checkbox"/> MR. / M	<input type="checkbox"/> MRS. / MME.	FIRST NAME / PRÉNOM		LAST NAME / NOM	
<input type="checkbox"/> MISS/MLE.	<input type="checkbox"/> MS.				
STREET NO / N° RUE		STREET NAME / RUE			APT.NO/APP/RR#
CITY / VILLE				PROVINCE	POSTAL CODE/CODE POSTAL
AREA CODE/IND. RÉG.	TELEPHONE/TÉLÉPHONE		E-MAIL/COURRIEL		
DID YOU PURCHASE A SERVICE CONTRACT FOR THIS APPLIANCE? AVEZ-VOUS ACHETÉ UN CONTRAT DE SERVICE POUR CET APPAREIL?			YES/OUI <input type="checkbox"/> NO/NON <input type="checkbox"/>	IF YES/SI OUI : EXPIRATION Y/A M D/J	
NAME OF SELLING DEALER / NOM DU MARCHAND				MODEL / MODÈLE	
INSTALLATION DATE / DATE D'INSTALLATION Y/A M D/J		CORRESPONDENCE CORRESPONDANCE	<input type="checkbox"/> ENGLISH <input type="checkbox"/> FRANÇAIS	SERIAL / SÉRIE	

☐ I do not wish to receive any promotional offers regarding this product.
Je ne désire pas recevoir d'offres promotionnelles concernant ce produit.

Refrigerator Warranty

All warranty service provided by our Factory Service Centers, or an authorized Customer Care® technician. To schedule service, contact us at 1.800.561.3344. Please have serial number and model number available when calling for service.

For The Period Of:	Mabe Will Replace:
One Year From the date of the original purchase	Any part of the refrigerator which fails due to a defect in materials or workmanship. During this limited one-year warranty, Mabe will also provide, free of charge, all labor and related service to replace the defective part.

What Mabe Will Not Cover:

- Service trips to your home to teach you how to use the product.
- Improper installation, delivery or maintenance.
- Failure of the product if it is abused, misused, or used for other than the intended purpose or used commercially.
- Loss of food due to spoilage.
- Damage caused after delivery.
- Replacement of house fuses or resetting of circuit breakers.
- Damage to the product caused by accident, fire, floods or acts of God.
- Incidental or consequential damage caused by possible defects with this appliance.
- Product not accessible to provide required service.

EXCLUSION OF IMPLIED WARRANTIES

Your sole and exclusive remedy is product repair as provided in this Limited Warranty. Any implied warranties, including the implied warranties of merchantability or fitness for a particular purpose, are limited to one year or the shortest period allowed by law.

This warranty is extended to the original purchaser and any succeeding owner for products purchased in Canada for home use within Canada. In-home warranty service will be provided in areas where it is available and deemed reasonable by Mabe to provide. If the product is located in an area where service by a GE Authorized Servicer is not available, you may be responsible for a trip charge or you may be required to bring the product to an Authorized GE Service location.

Warrantor: Mabe Canada Inc., Burlington, ON L7R 5B6

Staple your receipt here. Proof of the original purchase date is needed to obtain service under the warranty.

Consumer Support

Appliances Website

Have a question or need assistance with your appliance? Try the GE Appliances Website, any day of the year! For greater convenience and faster service, you can now download Owner's Manuals, order parts or even schedule service on-line at www.geappliances.ca

Schedule Service

Expert repair service is only one step away from your door. Get on-line and schedule your service at your convenience any day of the year! Or call **1.800.561.3344** during normal business hours.

Extended Warranties

Please consult your local listings for an extended warranty provider.

Parts and Accessories

Customers **in Canada** should consult the yellow pages for the nearest Mabe service center, visit our website or call 1.800.661.1616.

Contact Us

If you are not satisfied with the service you receive, contact us on our Website with all the details including your phone number, or write to: Director, Consumer Relations, Mabe Canada Inc.

In Canada: Director, Consumer Relations, Mabe Canada Inc. | Suite 310, 1 Factory Lane | Moncton, N.B. E1C 9M3
GEAppliances.ca/en/contact-us

Register Your Appliance

Register your new appliance on-line—at your convenience! Timely product registration will allow for enhanced communication and prompt service under the terms of your warranty, should the need arise. You may also mail in the pre-printed registration card included in the packing material. **www.geappliances.ca**.

Notes
