



## GM 6L80/90 FLARE 2-3 AND OR ENGAGEMENT CONCERNS

**COMPLAINT:** GM vehicles equipped with the 6L80/90 transmission, built prior to December of 2008 may exhibit a complaint of a flared 2-3 upshift or a delayed with harsh application into Forward and/or Reverse engagements. Note: this complaint has been linked more to a cold condition but may show up at any time.

**CAUSE:** The cause may be, leakage in the sealing ring area on the pump cover which feeds the 1-2-3-4 and 3-5-Reverse Clutch packs, causing a slow application, which can also cause elevated pressure as the TCM may try to adjust for the slow application.

**CORRECTION:** To correct this condition, replace the previous design pump cover with the one piece sealing rings, as shown in Figure 1, with the new design pump cover that now is a two piece design with anti-rotational tabs and a machining process that was performed on the ring land to accommodate the new tabs on the sealing rings. Note: This two piece sealing ring design was updated to prevent leakage in the 1-2-3-4 and 3-5-Reverse Clutch apply circuits and will retro-fit to previous models as a complete assembly. Refer to Figure 3 to see the mandatory pump alignment ring that must be used when replacing the pump cover. Figure 3 also shows the available alignment tools, and Figure 4 shows the bolt torque and sequence used when replacing the pump cover.

### SERVICE INFORMATION:

PUMPCOVER 2 PIECE SEALING RING DESIGN.....24248573  
(*New cover comes with rings already installed*)

**NOTE:** *This pump cover is also available from aftermarket sources.*

## PREVIOUS DESIGN PUMP COVER

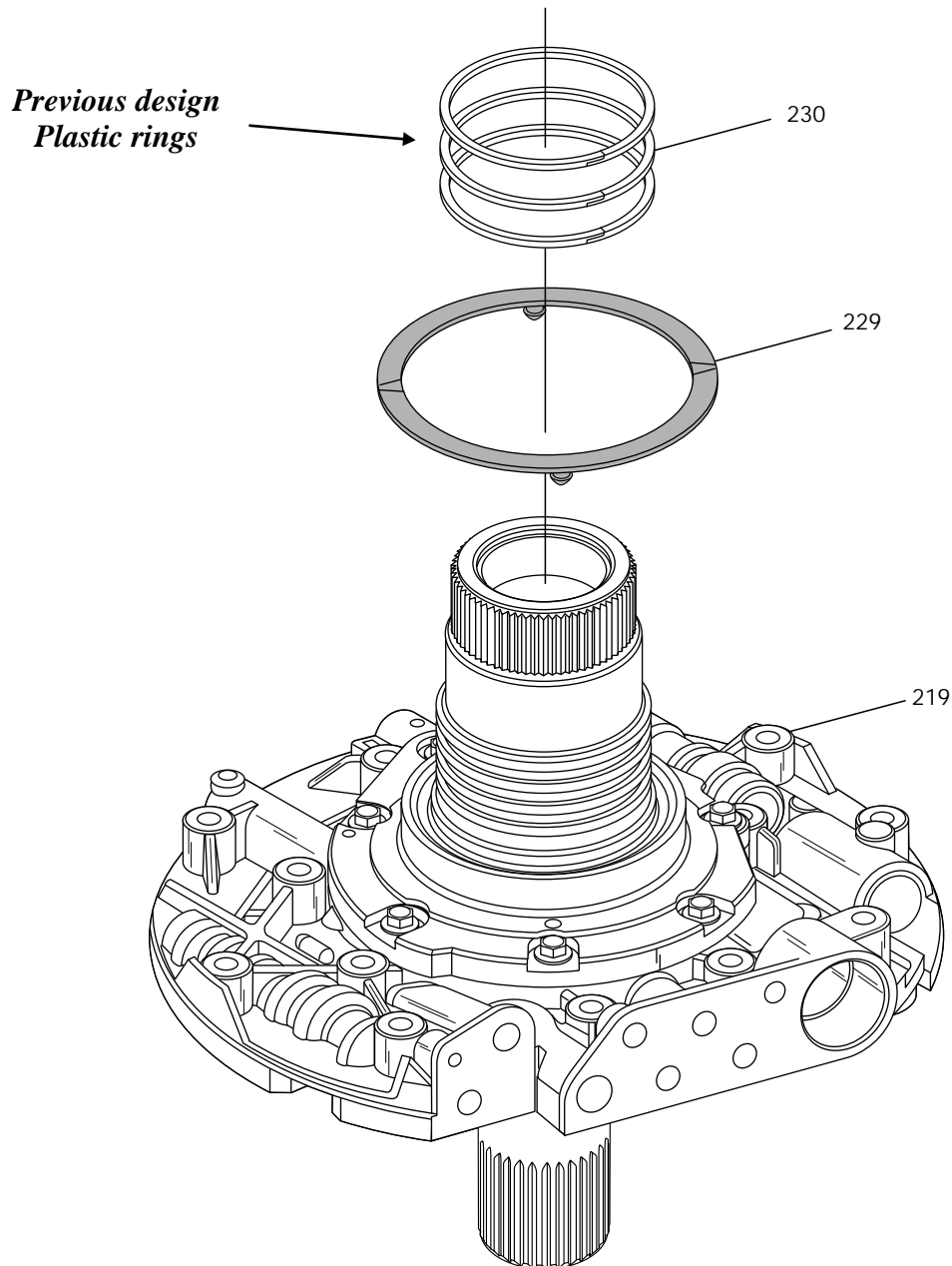

- 219 OIL PUMP COVER ASSEMBLY  
229 1-2-3-4 AND 3-5 REVERSE HOUSING THRUST WASHER  
230 1-2-3-4 AND 3-5 REVERSE SEAL RINGS (3 REQUIRED)

Copyright © 2013 ATSG

Figure 1

## NEW DESIGN PUMP COVER

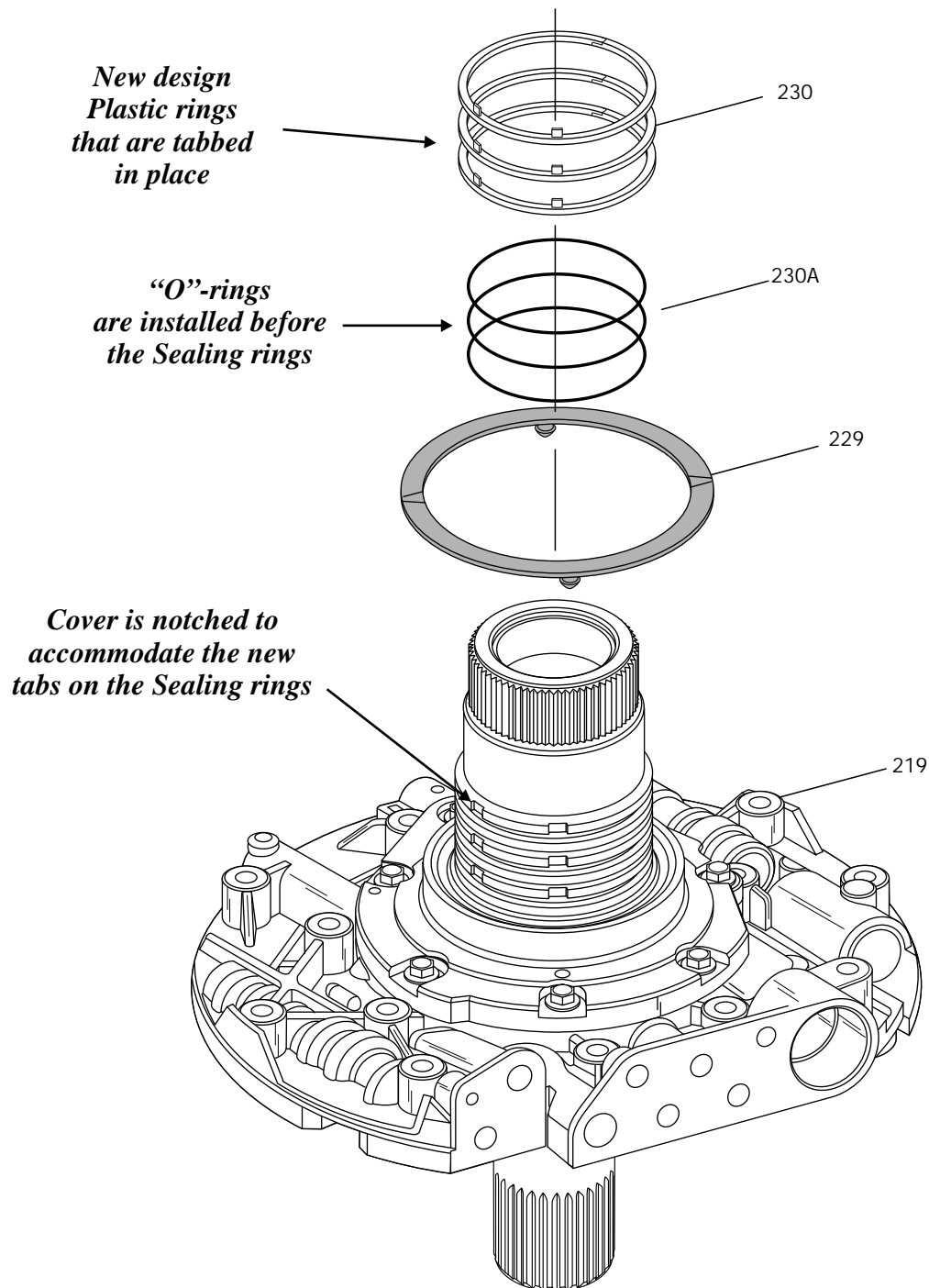

- 219 OIL PUMP COVER ASSEMBLY
- 229 1-2-3-4 AND 3-5 REVERSE HOUSING THRUST WASHER
- 230A 1-2-3-4 AND 3-5 REVERSE SEAL RINGS "O" -rings (3 REQUIRED)
- 230 1-2-3-4 AND 3-5 REVERSE SEAL RINGS (3 REQUIRED)

Copyright © 2013 ATSG

Figure 2

## ALIGNMENT TOOL INSTALLATION

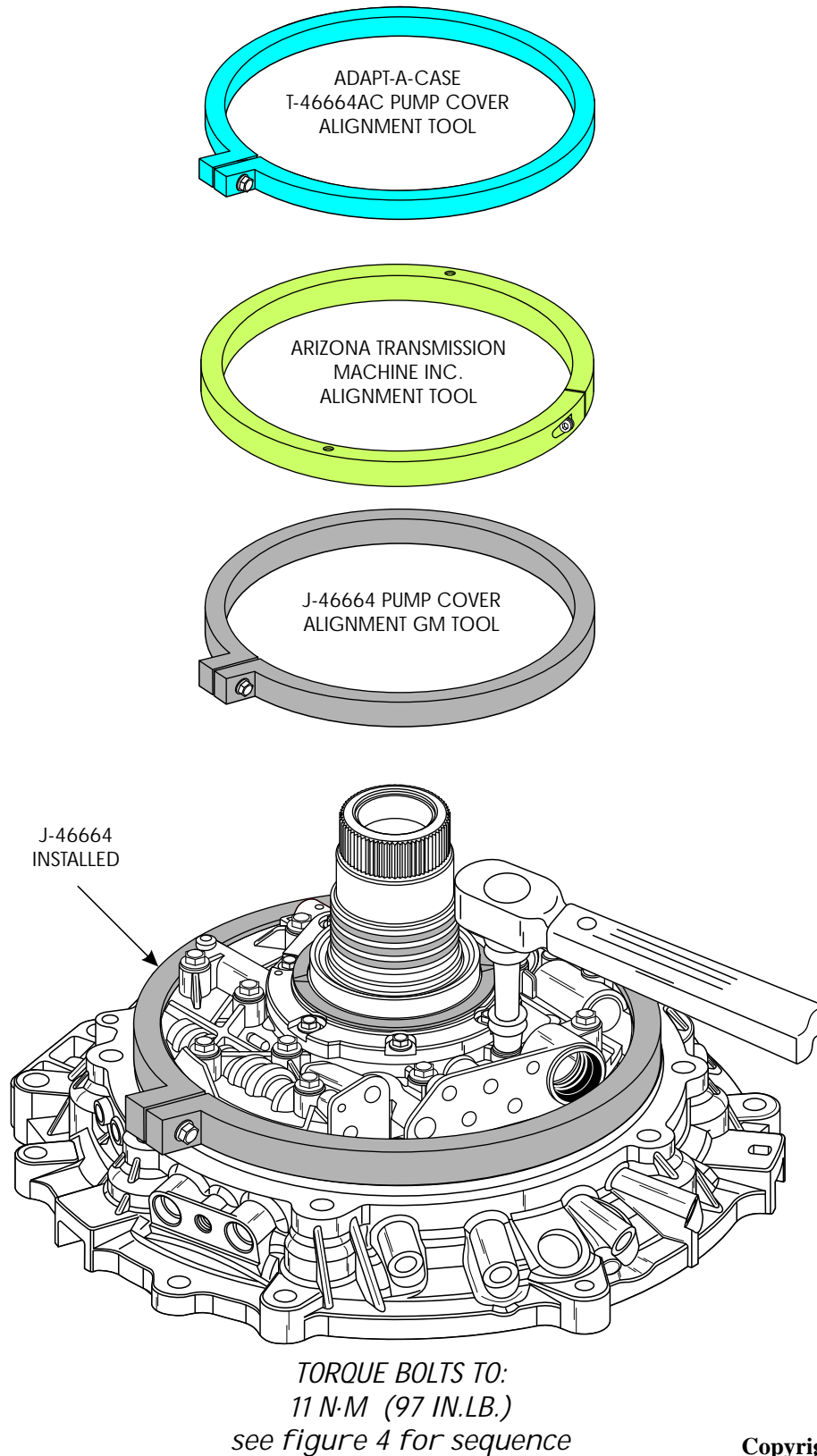

Copyright © 2013 ATSG

Figure 3

## BOLT TORQUE SEQUENCE

*TORQUE BOLTS TO:  
11 N·M (97 IN.LB.)*

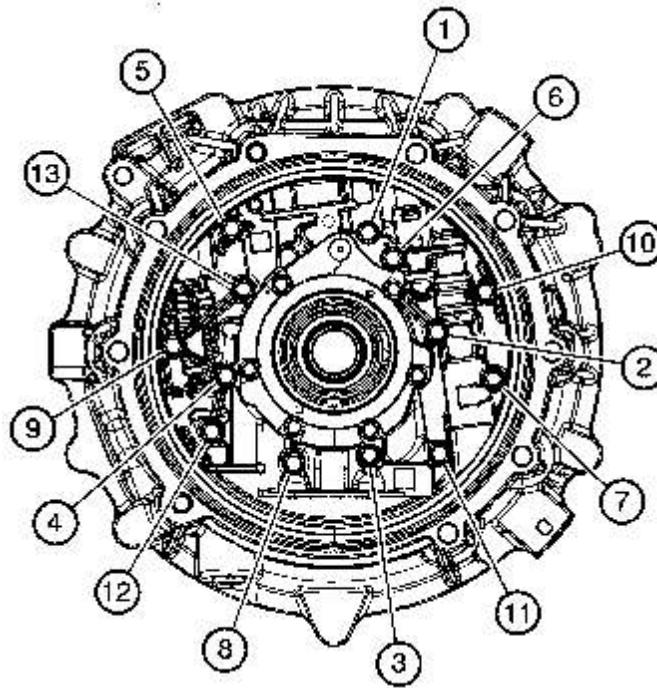

*Note: Torque the 13 oil pump cover retaining bolts to 11 Nm (97 in.lb.) using the sequence shown above starting with number 1.*

Copyright © 2013 ATSG

Figure 4