



# Technical Service Information

---

## **CHRYSLER 45RFE NO 3RD OR 4TH GEAR**

**COMPLAINT:** The vehicle exhibits a condition of no shift to 3rd or 4th gear. Vehicle has 1st and 2nd gear only.

**CAUSE:** The cause may be, broken accumulator cover bolts allowing the overdrive accumulator piston to come out far enough to exhaust all overdrive clutch feed oil. The overdrive clutch is applied in 3rd and 4th gears. Usually, the accumulator cover plate is also very badly bent and must be straightened, as it is not available from OEM individually. We suspect the accumulator bolts were not properly torqued to begin with.

**CORRECTION:** Straighten the accumulator cover plate and install new accumulator cover plate retaining bolts, as shown in Figure 1.

*Special Note: When reinstalling the new bolts, use red Lock-Tite® on the threads.*

## MAIN VALVE BODY EXPLODED VIEW

1. MAIN VALVE BODY CASTING.
2. 1/4" VITON CHECKBALLS (7 REQUIRED).
3. SOLENOID SWITCH VALVE LINE-UP
4. SOLENOID SWITCH VALVE LINE-UP PLASTIC RETAINING CLIP
5. MANUAL VALVE.
6. OVERDRIVE CLUTCH ACCUMULATOR PISTON AND SEALS.
7. OVERDRIVE CLUTCH ACCUMULATOR SPRING (SINGLE).
8. UNDERDRIVE CLUTCH ACCUMULATOR PISTON AND SEALS.
9. UNDERDRIVE CLUTCH ACCUMULATOR SPRINGS (DOUBLE).
10. 4TH CLUTCH ACCUMULATOR PISTON AND SEALS.
11. 4TH CLUTCH ACCUMULATOR SPRINGS (DOUBLE).
12. 2ND CLUTCH ACCUMULATOR PISTON AND SEALS.
13. 2ND CLUTCH ACCUMULATOR SPRINGS (DOUBLE).
14. LOW/REVERSE SWITCH VALVE.
15. LOW/REVERSE SWITCH VALVE BORE PLUG.
16. LOW/REVERSE ACCUMULATOR PISTON AND SEALS.
17. LOW/REVERSE ACCUMULATOR SPRINGS (DOUBLE).
18. ACCUMULATOR COVER PLATE.

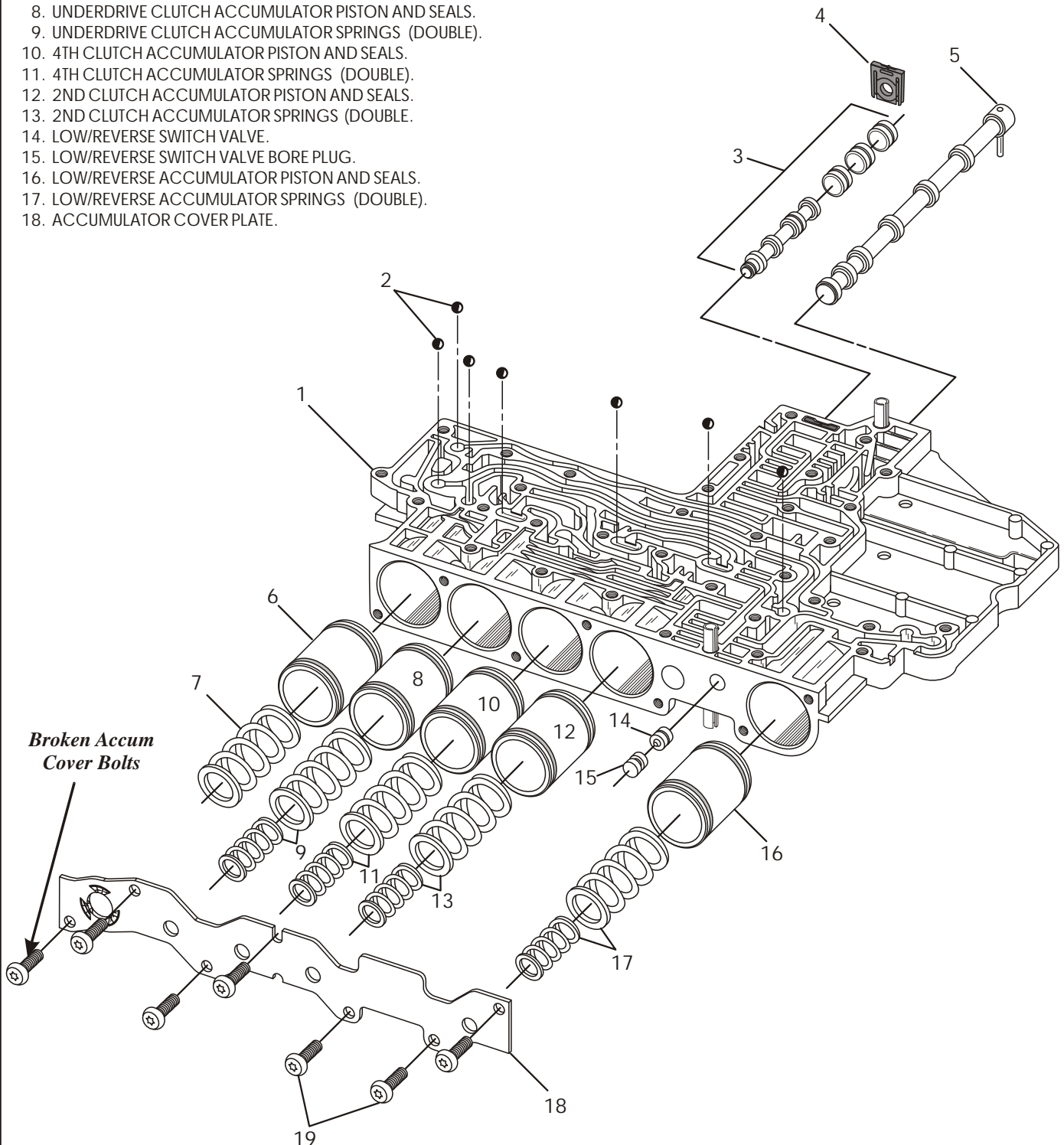

Copyright © 2004 ATSG

Figure 1