

## PICO Antibody Purification (AP) Kit

The **PICO Antibody Purification Kit** (#PICO-000050) contents must be stored at RT or 4°C for up to 6 months (see product labels for exact storage conditions). Find the date of expiry stated on the contents of the kit.

### Further information:

- The PICO Handbook and the PICO AP Kit User Manual: [www.actome.de/resources.html](http://www.actome.de/resources.html)
- Safety Data Sheets: [www.actome.de/resources.html](http://www.actome.de/resources.html)

### Notes before starting:

- Perform **all centrifugation steps** at 4°C, ~14,000 rcf and stated duration.
- Perform **quick spins** at RT, ~1,000 rcf, 20 s.
- Use a maximum of **1.3 mg antibody in 10 - 100 µl**.
- Always load **~1 ml air** into syringes (additional to the liquid) when washing to remove excess liquid from the column.

DAY 1

### The PICO AP protocol:

1. Prepare 3x 50 ml falcon tubes (filled with PBS, water, and one waste vessel).
2. Homogenize the resin by pipetting and load **20 µl resin** onto a Loading Column placed in a 1.5 ml reaction tube (break off the nozzle of the Loading Column).
3. Wash the resin with **2 ml PBS** (into the waste vessel) and remove the last traces of buffer with a quick spin.
4. Vortex the antibody for 5 s, quick spin and pipette the antibody onto the resin (**Figure 1**).
5. Wash the resin with **5 ml PBS**, then with **5 ml RNase-free water** and quick spin.
6. Place the Loading Column in a 1.5 ml reaction tube, already containing **4 µl Buffer A**. Add **36 µl Elution Buffer** to the column, mix by pipetting and incubate for 3 min at RT (**Critical! Don't exceed the 3 min!**). Recover the antibody by quick spin.
7. Transfer the antibody into a 100K Ultrafiltration Column, add **350 µl PBS** and centrifuge for 3 min (**Figure 2**). Discard flow-through. Add **400 µl PBS** and centrifuge for 15 min.
8. Flip over the column, place it into a new reaction tube and recover the antibody by quick spin. Transfer the antibody to a low protein binding tube, add **2 µl 10x Storage Buffer** and vortex for 5 s.
9. The purified antibody can be stored for **two months** at 4°C.

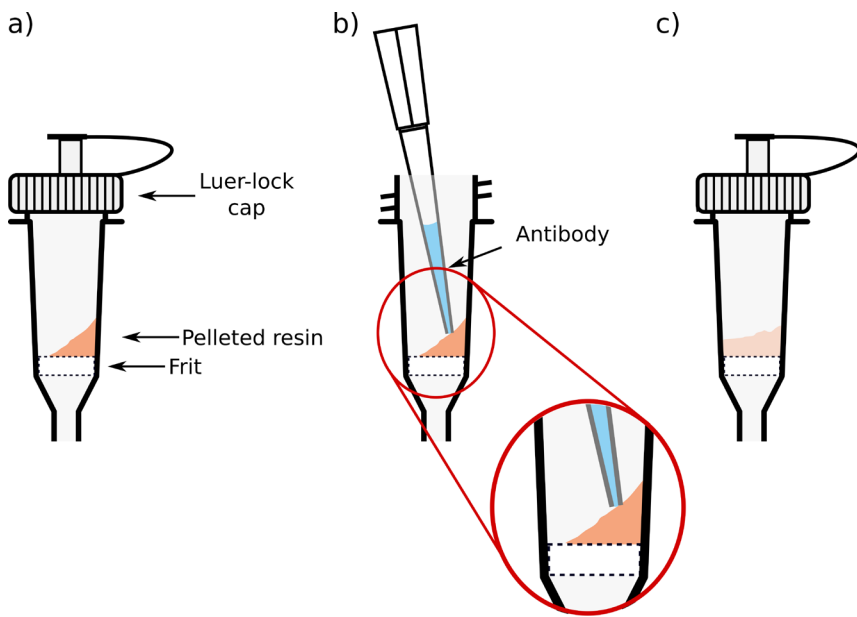

**Figure 1:** Handling of Loading Columns. **a)** After centrifugation, the resin forms a tilted surface. **b)** Pipette the liquid solution onto the middle of the tilted resin surface. Do not touch the plastic walls or the frit. **c)** Close the lid after pipetting.

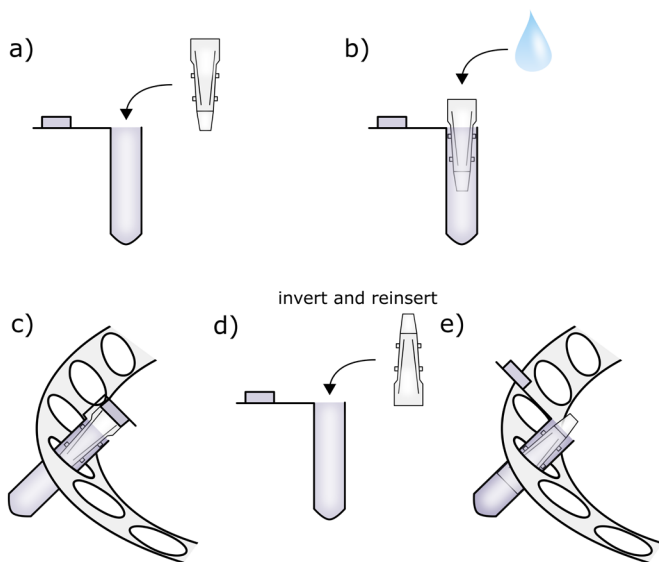

**Figure 2:** Handling of Ultrafiltration Columns. **a)** Place the Ultrafiltration Column into the collection tube. **b)** Load the liquid and cap the Ultrafiltration Column with the tube cap. **c)** Place the tube with the hinge of the cap and the side of the Ultrafiltration Column membrane outward. **d)** To recover the sample, place the Ultrafiltration Column into a new collection tube in an inverted position. **e)** Centrifuge.

Scan the QR code for the user manual:

